

Accesorios

Accessoires
Accessories
Accessori



Adaptadores

Adapteurs
Adaptors
Adattatori

1

Accesorios ORFS

Accessoires ORFS
ORFS Accessories
Accessori ORFS

2

Enchufes rápidos

Coupleurs rapides
Quick-release couplings
Innesti rapidi

3

Llaves paso, desviadores y racores giratorios

Robinets, diviseurs et raccords tournants
Ball valves, diverters and swivel fittings
Rubinetti, deviatori, raccordi girevoli

4

Protecciones

Protections/ressorts
Protections
Protezioni

5

Adaptadores

Adapteurs

Adaptors

Adattatori

1

Adaptadores BSP

Adaptateurs BSP | BSP Adaptors | Adattatori BSP

198

Adaptadores BSP

Adapteurs BSP | BSP Adaptors | Adattatori BSP

Adaptors

ORFS

Quick-release couplings

Ball valves, diverters

Protections

► **Uniones rectas macho** | Adapteur droit mâle-mâle | Straight adaptors male | Adattatori diritti maschio

201

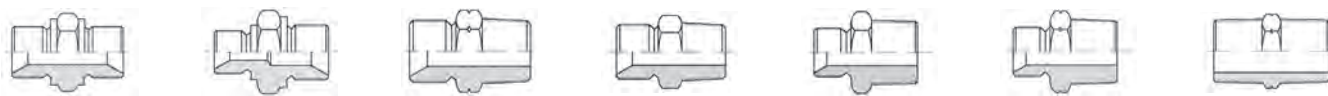

A1010 A1020 S1014 S1012 A1022 A1024 A1015



A1016 S1016

► **Uniones rectas macho-hembra** | Adapteur mâle-femelle | Adaptors male-female | Adattatori diritti maschio-femmina

202

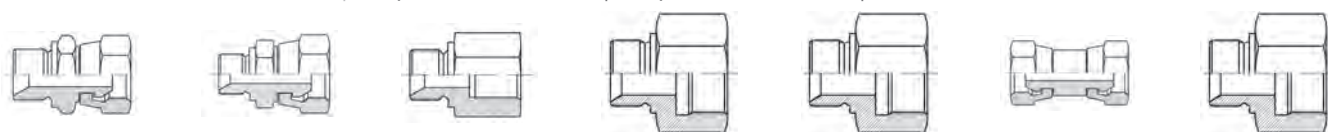

A1170 A1173 A1050 S1061 S106218 A1172 A1060



A1150

► **Tapones** | Bouchons adapteur | Plugs | Tappi

204

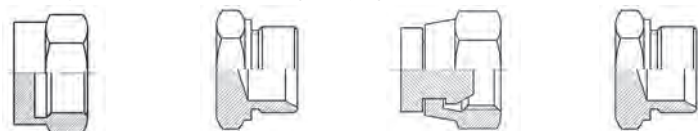

A1072 A1070 A1075 A1073

► **Uniones hembra y pasatabiques** | Unions femelle et passe cloison | Adaptors female and bulkheads | Adattatori femmina e passaparete

204



A1310 S103110 A1160 A1272

► **Orientables** | Adapteurs banjo | Banjos | Adattatori a occhio

205



A1090 A1094 A1092 A1093 S1092 A1096 A1140



A1112 A1111 A1113

► **Soldables** | Adapteurs à souder | Weldable adaptors | Adattatori a saldare

207



A1290



A1030

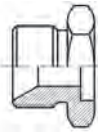

A1031

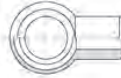

A1141

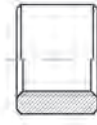

A1311

► **Codos accesoriales (tubo)** | Adapteurs coudes Accessorielles | Accessorial elbows | Adattatori a 90° tubolari

208



A1194

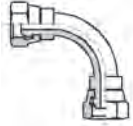

A1196



A1195

► **Codos en forja** | Adapteurs coudes en forge | Forging elbows | Adattatori a 90° forgiati

208



S1190



S1192



S1195



S1197



S1198

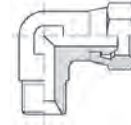

S1193



S1199

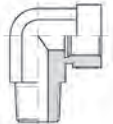

S1194

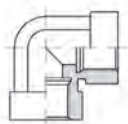

S1196



S1185



S860

► **Te en forja** | Adapteurs Tés en forge | Forging Tees | Adattatori a T forgiati

210



S1220



S1223



S1224



S1225

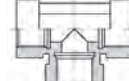

S1226

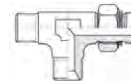

S1229



S1228



S865

► **Codos y Te en bloque (cuadrado)** | Adapteurs coudes et Tés en bloque | Square elbows and Tees | Adattatori a 90° e T da quadro senza saldatura

211



A1192



A2190



A2193

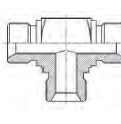

A2220



A2224

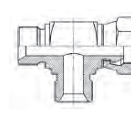

A2222



A2223

► **Juntas metal Buna y arandelas** | Bague BS | Bonded seals | Rondelle e rondelle Bonded

212



T210



T320

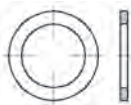

A1332

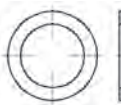

A1330

Adaptadores BSP

Adapteurs BSP
BSP Adaptors
Adattatori BSP

Adaptador macho-macho BSP (60°)



Adapteur mâle BSP x mâle BSP (60°)
Adaptor BSP male-BSP male (60°)
Niples di giunzione BSP (60°)

ROSCA THREAD		REFERENCIA PART N°	€
1/8" BSP	1/8" BSP	A101002	0,51
1/4" BSP	1/4" BSP	A101004	0,57
3/8" BSP	3/8" BSP	A101006	0,82
1/2" BSP	1/2" BSP	A101008	1,20
5/8" BSP	5/8" BSP	A101010	1,96
3/4" BSP	3/4" BSP	A101012	2,02
1" BSP	1" BSP	A101016	3,67
1"1/4 BSP	1"1/4 BSP	A101020	6,14
1"1/2 BSP	1"1/2 BSP	A101024	10,50
2" BSP	2" BSP	A101032	18,03

Reductor macho-macho BSP (60°)



Reducteur mâle BSP x mâle BSP (60°)
Reducer adaptor BSP male-BSP male (60°)
Niples di riduzione BSP (60°)

ROSCA THREAD		REFERENCIA PART N°	€
1/8" BSP	1/4" BSP	A10200204	0,70
1/8" BSP	3/8" BSP	A10200206	0,95
1/4" BSP	3/8" BSP	A10200406	0,90
1/4" BSP	1/2" BSP	A10200408	1,27
3/8" BSP	1/2" BSP	A10200608	1,18
3/8" BSP	3/4" BSP	A10200612	2,09
1/2" BSP	3/4" BSP	A10200812	1,96
1/2" BSP	1" BSP	A10200816	3,73
5/8" BSP	1/2" BSP	A10201008	2,59
5/8" BSP	3/4" BSP	A10201012	2,91
3/4" BSP	1" BSP	A10201216	3,73
3/4" BSP	1"1/4 BSP	A10201220	6,14
1" BSP	1"1/4 BSP	A10201620	6,14
1" BSP	1"1/2 BSP	A10201624	11,83
1"1/4 BSP	1"1/2 BSP	A10202024	9,11
1"1/4 BSP	2" BSP	A10202032	17,46
1"1/2 BSP	2" BSP	A10202432	17,46

Adaptador macho BSP (60°) - macho NPT

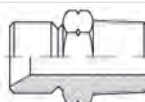

Adapteur mâle BSP (60°) x mâle briggs (NPT)
Adaptor BSP male (60°)-NPT male
Niples di congiunzione BSP (60°) - NPT

ROSCA THREAD		REFERENCIA PART N°	€
1/8" BSP	1/8" NPT	S101402	1,26
1/4" BSP	1/4" NPT	S101404	0,84
3/8" BSP	3/8" NPT	S101406	1,12
1/2" BSP	1/2" NPT	S101408	1,85
3/4" BSP	3/4" NPT	S101412	3,57
1" BSP	1" NPT	S101416	8,08
1"1/4 BSP	1"1/4 NPT	S101420	14,46
1"1/2 BSP	1"1/2 NPT	S101424	17,30
2" BSP	2" NPT	S101432	33,96

Adaptador macho BSP (60°) - macho BSPT

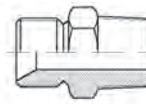

Adapteur mâle BSP (60°) x mâle gaz conique (BSPT)
Adaptor BSP male- BSPT male (60°)
Niples di congiunzione BSP (60°) - BSPT

ROSCA THREAD		REFERENCIA PART N°	€
1/8" BSP	1/8" BSPT	S101202	0,76
1/4" BSP	1/4" BSPT	S101204	0,95
3/8" BSP	3/8" BSPT	S101206	1,01
1/2" BSP	1/2" BSPT	S101208	1,39
3/4" BSP	3/4" BSPT	S101212	2,66
1" BSP	1" BSPT	S101216	5,88
1"1/4 BSP	1"1/4 BSPT	S101220	7,91
1"1/2 BSP	1"1/2 BSPT	S101224	10,75
2" BSP	2" BSPT	S101232	21,25

Reductor macho BSP (60°) - macho BSPT

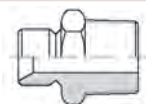

Reducteur mâle BSP (60°) x mâle gaz conique (BSPT)
Reducer adaptor BSP male (60°)-BSPT male
Niples di riduzione BSP (60°) - BSPT

ROSCA THREAD		REFERENCIA PART N°	€
1/8" BSP	1/4" BSPT	A10220204	7,17
1/4" BSP	3/8" BSPT	A10220406	1,66
1/4" BSP	1/2" BSPT	A10220408	12,89
3/8" BSP	1/2" BSPT	A10220608	2,60
3/8" BSP	3/4" BSPT	A10220612	14,62
1/2" BSP	1/4" BSPT	A10220804	2,67
1/2" BSP	3/4" BSPT	A10220812	18,62
5/8" BSP	3/4" BSPT	A10221012	9,86
3/4" BSP	1" BSPT	A10221216	6,43
1" BSP	1"1/4 BSPT	A10221620	57,30
1"1/4 BSP	1" BSPT	A10222016	15,67
1"1/4 BSP	1"1/2 BSPT	A10222024	78,81
1 1/2" BSP	1 1/4" BSPT	A10222420	57,50
1"1/2 BSP	2" BSPT	A10222432	47,28

Reductor macho BSP (60°) - macho NPT



Reducteur mâle BSP (60°) x mâle briggs (NPT)
Reducer adaptor BSP male (60°)-NPT male
Niples di riduzione BSP (60°) - NPT

ROSCA THREAD		REFERENCIA PART N°	€
1/8" BSP	1/4" NPT	A10240204	4,12
1/4" BSP	1/8" NPT	A10240402	1,67
1/4" BSP	3/8" NPT	A10240406	1,96
1/4" BSP	1/2" NPT	A10240408	2,83
3/8" BSP	1/2" NPT	A10240608	2,98
1/2" BSP	3/8" NPT	A10240806	3,27
1/2" BSP	3/4" NPT	A10240812	4,72
5/8" BSP	3/4" NPT	A10241012	13,72
3/4" BSP	1/2" NPT	A10241208	5,30
3/4" BSP	1" NPT	A10241216	20,24
1" BSP	1"1/4 NPT	A10241620	37,84
1"1/4 BSP	1"1/2 NPT	A10242024	51,66
1"1/2 BSP	2" NPT	A10242432	75,33

Adaptadores BSP

Adaptateurs BSP
BSP Adaptors
Adattatori BSP

Adaptador macho-macho NPT

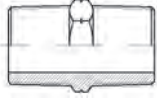

Adaptateur mâle briggs (NPT) x mâle briggs (NPT)
Adaptor NPT male-NPT male
Niples di congiunzione NPT

ROSCA THREAD		REFERENCIA PART N°	€
1/4" NPT	1/4" NPT	A10150404	1,34
3/8" NPT	3/8" NPT	A10150606	1,92
1/2" NPT	1/2" NPT	A10150808	2,42
3/4" NPT	3/4" NPT	A10151212	4,01
1" NPT	1" NPT	A10151616	6,09

Adaptador macho-macho Métrico (60°)



Adaptateur mâle DIN x mâle DIN Métrique (60°)
Adaptor Metric male-male (60°)
Niples di giunzione Metrico (60°)

ROSCA THREAD		REFERENCIA PART N°	€
M12x1.5	M12x1.5	S101612	1,67
M14x1.5	M14x1.5	S101614	1,05
M16x1.5	M16x1.5	S101616	2,26
M18x1.5	M18x1.5	S101618	2,15
M22x1.5	M22x1.5	S101622	3,62
M26x1.5	M26x1.5	S101626	6,44

Adaptador macho-macho BSPT

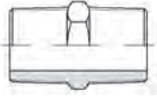

Adaptateur mâle gaz conique (BSPT) x mâle gaz conique (BSPT)
Adaptor BPST male-BSPT male
Niples di congiunzione BSPT

ROSCA THREAD		REFERENCIA PART N°	€
1/4" BSPT	1/4" BSPT	A10160404	1,50
3/8" BSPT	3/8" BSPT	A10160606	2,17
1/2" BSPT	1/2" BSPT	A10160808	2,51
3/4" BSPT	3/4" BSPT	A10161212	3,84
1" BSPT	1" BSPT	A10161616	6,60

Adap. macho - hembra giratoria BSP (60°)



Adaptateur mâle BSP x femelle tournante BSP (60°)
Adaptor BSP male-BSP swivel female (60°)
Niples di riduzione maschio-femmina girevole BSP (60°)

ROSCA THREAD		REFERENCIA PART N°	€
1/4" BSP	1/4" BSP	A117004	1,59
3/8" BSP	3/8" BSP	A117006	1,71
1/2" BSP	1/2" BSP	A117008	2,40
3/4" BSP	3/4" BSP	A117012	3,73
1" BSP	1" BSP	A117016	7,08
1"1/4 BSP	1"1/4 BSP	A117020	15,24
1"1/2 BSP	1"1/2 BSP	A117024	18,71

Reductor macho - hembra giratoria BSP (60°)



Reducteur mâle BSP x femelle tournante BSP (60°)
Reducer BSP male-BSP swivel female (60°)
Niples di riduzione maschio-femmina girevole BSP (60°)

ROSCA THREAD		REFERENCIA PART N°	€
M 1/8" BSP	H 1/4" BSP	A11730204	1,50
M 1/4" BSP	H 3/8" BSP	A11730406	1,95
M 3/8" BSP	H 1/2" BSP	A11730608	2,38
M 1/2" BSP	H 3/4" BSP	A11730812	3,68
M 3/4" BSP	H 1" BSP	A11731216	6,00
M 3/4" BSP	H 1"1/4 BSP	A11731220	35,06
M 1" BSP	H 1"1/4 BSP	A11731620	14,69
M 1"1/4 BSP	H 1"1/2 BSP	A11732024	26,08
M 1" 1/2 BSP	H 2" BSP	A11732432	41,82

Adaptadores BSP

Adapteurs BSP
BSP Adaptors
Adattatori BSP

Prolongador macho - hembra fija BSP (60°)

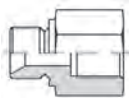

Prolongateur mâle BSP x femelle gaz fixe (60°)

Adaptor BSP male-BPS fixed female (60°)

Prolunga maschio-femmina BSP (60°)

ROSCA THREAD		REFERENCIA PART N°	€
1/8" BSP	1/8" BSP	A105002	0,94
1/4" BSP	1/4" BSP	A105004	0,89
3/8" BSP	3/8" BSP	A105006	1,37
1/2" BSP	1/2" BSP	A105008	1,81
3/4" BSP	3/4" BSP	A105012	2,46
1" BSP	1" BSP	A105016	3,97
1"1/4 BSP	1"1/4 BSP	A105020	8,60
1"1/2 BSP	1"1/2 BSP	A105024	13,94
2" BSP	2" BSP	A105032	22,03

Reductor macho BSP (60°) - hembra fija Métrica



Reducteur mâle BSP (60°) x femelle fixe Métrique

Reducer adaptor BSP male (60°) - Metric fixed female

Niples di riduzione maschio BSP (60°)-femmina fissa Metrica

ROSCA THREAD		REFERENCIA PART N°	€
3/8" BSP	M14x1.5	S10610614	5,99
3/8" BSP	M18x1.5	S10610618	5,51
1/2" BSP	M18x1.5	S10610818	5,78
1/2" BSP	M20x1.5	S10610820	9,07
1/2" BSP	M22x1.5	S10610822	9,08

Reductor macho Métrico (60°) - hembra fija BSP

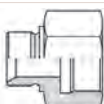

Reducteur mâle Métrique (60°) x femelle fixe gaz

Reducer adaptor Metric male (60°) - BSP fixed female

Niples di riduzione maschio Metrico (60°)-femmina fissa BSP

ROSCA THREAD		REFERENCIA PART N°	€
M18x1.5	1/4" BSP	S10621804	3,97
M18x1.5	3/8" BSP	S10621806	3,97
M18x1.5	1/2" BSP	S10621808	3,83

Adap. hembra giratoria - hembra giratoria BSP (60°)

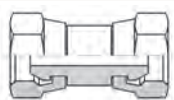

Adapteur femelle tournante BSP x femelle tournante BSP (60°)

Adaptor BSP swivel female - BSP swivel female (60°)

Niples femminas-femmina girevole BSP (60°)

ROSCA THREAD		REFERENCIA PART N°	€
1/4" BSP	1/4" BSP	A117204	2,17
3/8" BSP	3/8" BSP	A117206	2,82
1/2" BSP	1/2" BSP	A117208	4,26
3/4" BSP	3/4" BSP	A117212	5,63
1" BSP	1" BSP	A117216	9,17
1" 1/4 BSP	1" 1/4 BSP	A117220	26,12
1" 1/2 BSP	1" 1/2 BSP	A117224	38,22
2" BSP	2" BSP	A117232	94,67

Reductor macho - hembra fija BSP (60°)

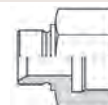

Prolongateur reducteur mâle BSP x femelle gaz fixe (60°)

Reducer adaptor BPS male- BSP fixed female (60°)

Prolunga di riduzione maschio-femmina BSP (60°)

ROSCA THREAD		REFERENCIA PART N°	€
M 1/8" BSP	H 1/4" BSP	A10600204	1,01
M 1/8" BSP	H 3/8" BSP	A10600206	1,08
M 1/4" BSP	H 1/8" BSP	A10600402	1,01
M 1/4" BSP	H 3/8" BSP	A10600406	1,37
M 1/4" BSP	H 1/2" BSP	A10600408	2,39
M 3/8" BSP	H 1/8" BSP	A10600602	1,81
M 3/8" BSP	H 1/4" BSP	A10600604	1,23
M 3/8" BSP	H 1/2" BSP	A10600608	1,81
M 3/8" BSP	H 3/4" BSP	A10600612	2,46
M 1/2" BSP	H 1/4" BSP	A10600804	2,39
M 1/2" BSP	H 3/8" BSP	A10600806	1,81
M 1/2" BSP	H 3/4" BSP	A10600812	1,81
M 1/2" BSP	H 1" BSP	A10600816	3,97
M 3/4" BSP	H 3/8" BSP	A10601206	2,53
M 3/4" BSP	H 1/2" BSP	A10601208	2,46
M 3/4" BSP	H 1" BSP	A10601216	3,90
M 3/4" BSP	H 1 1/4" BSP	A10601220	9,10
M 1" BSP	H 1/2" BSP	A10601608	3,97
M 1" BSP	H 3/4" BSP	A10601612	3,90
M 1" BSP	H 1"1/4 BSP	A10601620	9,10
M 1"1/4 BSP	H 1" BSP	A10602016	7,93
M 1 1/4" BSP	H 2" BSP	A10602032	47,33
M 1" 1/2 BSP	H 1" 1/4 BSP	A10602420	24,31
M 1"1/2 BSP	H 2" BSP	A10602432	48,46

Tapón reductor macho - hembra fija BSP (60°)



Bouchon reducteur mâle BSP x femelle gaz fixe (60°)

Reducer plug BSP male-BSP fixed female (60°)

Tappo di riduzione maschio-femmina BSP Tappo di riduzione maschio-femmina BSP (60°)

ROSCA THREAD		REFERENCIA PART N°	€
M 1/4" BSP	H 1/8" BSP	A11500402	0,63
M 3/8" BSP	H 1/8" BSP	A11500602	1,01
M 3/8" BSP	H 1/4" BSP	A11500604	0,95
M 1/2" BSP	H 1/4" BSP	A11500804	1,33
M 1/2" BSP	H 3/8" BSP	A11500806	1,33
M 3/4" BSP	H 3/8" BSP	A11501206	2,09
M 3/4" BSP	H 1/2" BSP	A11501208	1,96
M 1" BSP	H 1/2" BSP	A11501608	3,35
M 1" BSP	H 3/4" BSP	A11501612	3,35
M 1"1/4 BSP	H 3/4" BSP	A11502012	5,88
M 1"1/4 BSP	H 1" BSP	A11502016	5,88
M 1"1/2 BSP	H 1"1/4 BSP	A11502420	7,72
M 2" BSP	H 1" 1/4 BSP	A11503220	16,76
M 2" BSP	H 1"1/2 BSP	A11503224	16,76

Adaptadores BSP

Adaptateurs BSP
BSP Adaptors
Adattatori BSP

**Tapón hembra hexagonal
rosca BSP (60°)**

Bouchon femelle gaz (60°)
BSP fixed female plug (60°)
Tappo femmina fissa BSP (60°)

ROSCA THREAD	REFERENCIA PART N°	€
1/8" BSP	A107202	1,06
1/4" BSP	A107204	1,06
3/8" BSP	A107206	1,31
1/2" BSP	A107208	1,80
3/4" BSP	A107212	2,35
1" BSP	A107216	3,48
1"1/4 BSP	A107220	15,17
1"1/2 BSP	A107224	23,23
2" BSP	A107232	35,13

**Tapón macho hexagonal
rosca BSP (60°)**

Bouchon mâle BSP (60°)
BSP hexagonal male plug (60°)
Tappo maschio esagonale BSP (60°)

ROSCA THREAD	REFERENCIA PART N°	€
1/8" BSP	A107002	0,57
1/4" BSP	A107004	0,57
3/8" BSP	A107006	0,76
1/2" BSP	A107008	1,08
3/4" BSP	A107012	1,83
1" BSP	A107016	3,04
1"1/4 BSP	A107020	6,20
1"1/2 BSP	A107024	8,35
2" BSP	A107032	16,76

**Tapón hembra giratoria BSP
(60°)**

Bouchon femelle tournante BSP (60°)
BSP swivel female plug (60°)
Tappo femmina girevole BSP (60°)

ROSCA THREAD	REFERENCIA PART N°	€
1/4" BSP	A107504	0,87
3/8" BSP	A107506	1,23
1/2" BSP	A107508	1,58
3/4" BSP	A107512	2,46
1" BSP	A107516	3,97
1"1/4 BSP	A107520	9,17
1"1/2 BSP	A107524	13,36
2" BSP	A107532	22,10

**Tapón macho hexagonal
rosca Métrica**

Bouchon mâle Métrique (60°)
Metric hexagonal male plug
Tappo maschio esagonale Metrico

ROSCA THREAD	REFERENCIA PART N°	€
M10x1	A10731001	2,12
M12x1.5	A10731215	2,15
M14x1.5	A10731415	2,55
M16x1.5	A10731615	2,77
M18x1.5	A10731815	3,01
M20x1.5	A10732015	3,58
M22x1.5	A10732215	4,40
** M24x1.5	A10732415	4,50

** Hasta fin de existencias // Jusqu'à la fin du stock // Until end of stock // Fino ad esaurimento scorta

**Manguito roscado hembra
BSP redondo**

Manchon femelle gaz x femelle gaz ronde
Adaptor BSP female fixed-BSP female fixed
Borchia a saldare femmina-femmina BSP

ROSCA THREAD	REFERENCIA PART N°	€
1/8" BSP	A131002	0,72
1/4" BSP	A131004	0,80
3/8" BSP	A131006	1,08
1/2" BSP	A131008	1,52
3/4" BSP	A131012	2,31
1" BSP	A131016	4,55
1" 1/4 BSP	A131020	5,27
1"1/2 BSP	A131024	7,73
2" BSP	A131032	10,84

**Manguito roscado hembra
BSP hexagonal**



Manchon femelle gaz x femelle gaz hexagonal
Hexagonal adaptor BSP fixed female-BSP fixed female
Prolunga esagonale femmina-femmina BSP

ROSCA THREAD	REFERENCIA PART N°	€
1/4" BSP	S1031004	1,37
3/8" BSP	S1031006	1,88
1/2" BSP	S1031008	2,17
3/4" BSP	S1031012	2,82
1" BSP	S1031016	5,63
1" 1/4 BSP	S1031020	14,37
1" 1/2 BSP	S1031024	19,29

Adaptadores BSP

Adaptateurs BSP
BSP Adaptors
Adattatori BSP

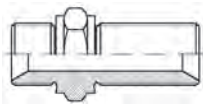
Pasatabiques sin tuerca BSP cono 60°



Passe-cloison mâle BSP x mâle BSP sans équiper (60°)
Straight bulkhead adaptor without nuts (60°)
Nipples passaparete BSP

ROSCA THREAD		REFERENCIA PART N°	€
1/4" BSP	1/4" BSP	A116004	1,44
3/8" BSP	3/8" BSP	A116006	1,76
1/2" BSP	1/2" BSP	A116008	2,40
3/4" BSP	3/4" BSP	A116012	3,71
1" BSP	1" BSP	A116016	6,59
1" 1/4 BSP	1" 1/4 BSP	A116020	19,12
1" 1/2 BSP	1" 1/2 BSP	A116024	42,01

Tuerca pasatabiques BSP



Contre-écrou passe-cloison gaz
Conter nut for bulkhead screw-joints
Controdado per passaparete BSP

ROSCA THREAD		REFERENCIA PART N°	€
1/4" BSP	1/4" BSP	A127204	0,34
3/8" BSP	3/8" BSP	A127206	0,47
1/2" BSP	1/2" BSP	A127208	0,72
3/4" BSP	3/4" BSP	A127212	1,01
1" BSP	1" BSP	A127216	2,42
1" 1/4 BSP	1" 1/4 BSP	A127220	4,62
1" 1/2 BSP	1" 1/2 BSP	A127224	6,37

Tornillo orientable simple BSP

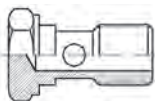

Vis creuse simple pour banjo filetage gaz
BSP Bolt for banjo
Bullone forato BSP

ROSCA THREAD	REFERENCIA PART N°	€
1/8" BSP	A109002	1,15
1/4" BSP	A109004	1,01
3/8" BSP	A109006	1,14
1/2" BSP	A109008	1,92
3/4" BSP	A109012	4,21
1" BSP	A109016	9,22
1" 1/4 BSP	A109020	28,37
1" 1/2 BSP	A109024	157,75

Tornillo orientable prolongado BSP

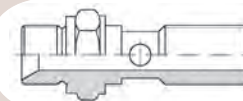

Vis creuse simple prolongué pour banjo
BSP Extended bolt for banjo
Bullone forato prolungato BSP

ROSCA THREAD		REFERENCIA PART N°	€
1/4" BSP	1/4" BSP	A109204	2,18
3/8" BSP	3/8" BSP	A109206	2,79
1/2" BSP	1/2" BSP	A109208	3,80
3/4" BSP	3/4" BSP	A109212	5,43
1" BSP	1" BSP	A109216	10,77

Tornillo orientable reductor BSP



Vis creuse simple reduit pour banjo x mâle BSP
BSP Reducer bolt for banjo
Bullone forato di riduzione BSP

ROSCA THREAD		REFERENCIA PART N°	€
1/4" BSP	3/8" BSP	A10930406	2,79
3/8" BSP	1/2" BSP	A10930608	3,80
1/2" BSP	3/4" BSP	A10930812	5,43
3/4" BSP	1" BSP	A10931216	10,77

Tornillo orientable doble BSP

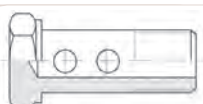

Vis creuse double pour banjo filetage gaz
BSP Double bolt for banjo
Bullone forato doppio BSP

ROSCA THREAD	REFERENCIA PART N°	€
1/4" BSP	A109404	1,87
3/8" BSP	A109406	2,28
1/2" BSP	A109408	4,74
3/4" BSP	A109412	6,38
1" BSP	A109416	13,39

Adaptadores BSP

Adaptateurs BSP
BSP Adaptors
Adattatori BSP

Tornillo orientable simple rosca Métrica

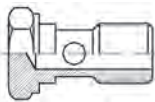

Vis creuse simple pour banjo filetage Métrique
Metric bolt for banjo
Bullone forato Metrico

ROSCA THREAD	REFERENCIA PART N°	€
M8x1	S109208	0,75
M10x1	S109210	1,52
M12x1.5	S109212	1,79
M14x1.5	S109214	1,33
M16x1.5	S109216	1,74
M18x1.5	S109218	3,28
M22x1.5	S109222	4,11
M26x1.5	S109226	11,33
M30x1.5	S109230	15,75

Tornillo orientable doble rosca Métrica

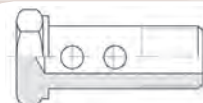

Vis creuse double pour banjo filetage Métrique
Metric double bolt for banjo
Bullone forato doppio Metrico

ROSCA THREAD	REFERENCIA PART N°	€
M8x1	A10960801	3,39
M10x1	A10961001	4,13
M12x1.5	A10961215	9,03
M14x1.5	A10961415	9,61
M18x1.5	A10961815	6,65

Esférico BSP - macho BSP (60°)



Banjo passage gaz x mâle BSP (60°)
BSP Banjo-BSP male (60°)
Adattatore ad occhio filettato BSP

ROSCA THREAD	Ø	REFERENCIA PART N°	€
1/8" BSP	1/4"	A114002	4,46
1/4" BSP	1/4"	A114004	1,59
3/8" BSP	3/8"	A114006	2,34
1/2" BSP	1/2"	A114008	2,59
3/4" BSP	3/4"	A114012	4,59
1" BSP	1"	A114016	10,85

Esférico BSP con alargadera-macho BSP (60°)

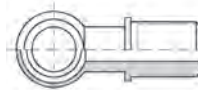

Banjo prolongé passage gaz x mâle BSP
BSP Banjo with extension-BSP male 60°
Adattatore ad occhio con prolunga maschio

ROSCA THREAD	Ø	REFERENCIA PART N°	€
3/8" BSP	3/8"	A111206	6,73
1/2" BSP	3/8"	A11120608	10,04
1/2" BSP	1/2"	A111208	9,34

Esférico BSP con alargadera-hembra giratoria BSP



Banjo prolongé passage gaz femelle tournante
BSP Banjo with extension-BSP swivel female
Adattatore ad occhio con prolunga femmina girevole

ROSCA THREAD	Ø	REFERENCIA PART N°	€
1/2" BSP	1/2"	A111108	11,01

Esférico BSP con alargadera-hembra fija BSP

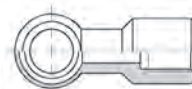

Banjo prolongé passage gaz x femelle fixe BSP
BSP Banjo with extension-BSP fixed female
Adattatore ad occhio con prolunga femmina fissa

ROSCA THREAD	Ø	REFERENCIA PART N°	€
3/8" BSP	3/8"	A111306	6,07
1/2" BSP	1/2"	A111308	11,83

Adaptadores BSP

Adaptateurs BSP
BSP Adaptors
Adattatori BSP

Empalme liso soldable rosca BSP (60°)



Embout mâle lisse à souder gaz cyl BSP (60°)

Welding union BSP male (60°)

Mezzo nipples tondo a saldare BSP

ROSCA THREAD	REFERENCIA PART N°	€
1/8" BSP	A129002	1,04
1/4" BSP	A129004	0,58
3/8" BSP	A129006	0,69
1/2" BSP	A129008	0,87
3/4" BSP	A129012	1,59
1" BSP	A129016	3,68
1"1/4 BSP	A129020	12,28
1"1/2 BSP	A129024	11,35
2" BSP	A129032	13,24

Racor macho BSP (60°) soldable interior



Mamelon BSP hexagone à souder interieur sw (60°)

Welding adaptor BSP male (60°) (internal welding)

Raccordo maschio BSP a saldare di tasca

ROSCA THREAD	REFERENCIA PART N°	€
1/8" BSP	A103102	1,49
1/4" BSP	A103104	0,70
3/8" BSP	A103106	0,89
1/2" BSP	A103108	1,46
3/4" BSP	A103112	3,42
1" BSP	A103116	4,30
1"1/4 BSP	A103120	9,68
1"1/2 BSP	A103124	13,60
2" BSP	A103132	17,01

Racor macho BSP (60°) soldable exterior



Mamelon BSP hexagone à souder exterior bw (60°)

Welding adaptor BSP male (60°) (external welding)

Raccordo maschio BSP a saldare

ROSCA THREAD	REFERENCIA PART N°	€
1/8" BSP	A103002	1,71
1/4" BSP	A103004	0,73
3/8" BSP	A103006	0,95
1/2" BSP	A103008	1,24
3/4" BSP	A103012	2,04
1" BSP	A103016	3,06
1"1/4 BSP	A103020	7,13
1"1/2 BSP	A103024	8,87
2" BSP	A103032	13,60

Esférico BSP soldable exterior



Banjo passage gaz à souder (bw)

BSP Banjo external welding

Raccordo a occhio BSP a saldare

ROSCA THREAD	Ø	REFERENCIA PART N°	€
1/8" BSP	1/8"	A114102	7,93
1/4" BSP	1/4"	A114104	1,59
3/8" BSP	3/8"	A114106	2,26
1/2" BSP	1/2"	A114108	2,34
3/4" BSP	3/4"	A114112	4,68
1" BSP	1"	A114116	11,27

Soldables para cilindros



Raccords à souder pour verins

Welding nipples for cylinders

Borchia a saldare femmina-femmina

ROSCA THREAD	REFERENCIA PART N°	€
1/4" BSP	A13110400000	1,09
3/8" BSP	A13110600000	1,34
1/2" BSP	A13110800000	1,67
3/4" BSP	A13111200000	2,51

Adaptadores BSP

Adaptateurs BSP
BSP Adaptors
Adattatori BSP

Adaptors

ORFS

Quick-release couplings

Ball valves, diverters

Protections

Codo tubo 90° macho-hembra giratoria BSP (60°)



Adaptateur coude 90° tube mâle BSP x femelle tournante BSP (60°)
90° Elbow tube BSP female-male
Curva 90° maschio-femmina girevole BSP 60°

ROSCA THREAD		REFERENCIA PART N°	€
1/4" BSP	1/4" BSP	A119404	3,96
3/8" BSP	3/8" BSP	A119406	5,13
1/2" BSP	1/2" BSP	A119408	6,28
3/4" BSP	3/4" BSP	A119412	9,83
1" BSP	1" BSP	A119416	14,65
1"1/4 BSP	1"1/4 BSP	A119420	32,27
1"1/2 BSP	1"1/2 BSP	A119424	48,10
2" BSP	2" BSP	A119432	97,62

Codo tubo 90° hembra giratoria-hembra giratoria BSP (60°)



Adaptateur coude 90° tube femelle tournante BSP x femelle tournante BSP (60°)
90° Elbow tube BSP swivel female-BSP swivel female
Curva 90° femmina-femmina girevole BSP 60°

ROSCA THREAD		REFERENCIA PART N°	€
1/4" BSP	1/4" BSP	A119604	5,19
3/8" BSP	3/8" BSP	A119606	5,99
1/2" BSP	1/2" BSP	A119608	7,47
3/4" BSP	3/4" BSP	A119612	11,71
1" BSP	1" BSP	A119616	16,07

Codo tubo 45° macho-hembra giratoria BSP (60°)



Adaptateur coude 45° tube mâle BSP x femelle tournante BSP (60°)
45° Elbow tube BSP female-male
Curva 45° maschio-femmina girevole BSP 60°

ROSCA THREAD		REFERENCIA PART N°	€
1/4" BSP	1/4" BSP	A119504	4,40
3/8" BSP	3/8" BSP	A119506	5,09
1/2" BSP	1/2" BSP	A119508	7,14
3/4" BSP	3/4" BSP	A119512	10,82
1" BSP	1" BSP	A119516	16,28

Codo 90° macho-macho BSP (60°) forja



Adaptateur coude 90° mâle BSP x mâle BSP (60°) forge
90° elbow male bsp-male bsp (60°) forge
Adattatore a 90° maschio-maschio BSP (60°) forgiato

ROSCA THREAD		REFERENCIA PART N°	€
1/4" BSP	1/4" BSP	S119004	2,09
3/8" BSP	3/8" BSP	S119006	2,46
1/2" BSP	1/2" BSP	S119008	3,18
3/4" BSP	3/4" BSP	S119012	4,98
1" BSP	1" BSP	S119016	10,18
1"1/4 BSP	1"1/4 BSP	S119020	26,65

Codo 90° macho BSP (60°) -macho BSPT forja



Adaptateur coude 90° mâle BSP x mâle gaz conique (BSPT) (60°) forge
90° Elbow BSP male (60°)-BSPT male forge
Adattatore a 90° maschio BSP (60°) - maschio BSPT forgiato

ROSCA THREAD		REFERENCIA PART N°	€
1/8" BSP	1/8" BSPT	S119202	1,59
1/4" BSP	1/8" BSPT	S119204	1,88
3/8" BSP	3/8" BSPT	S119206	2,75
1/2" BSP	1/2" BSPT	S119208	3,54
3/4" BSP	3/4" BSPT	S119212	5,35
1" BSP	1" BSPT	S119216	12,79

Codo 90° macho-macho BSPT forja



Adaptateur coude 90° mâle gaz conique (BSPT) x mâle gaz conique (BSPT) forge
90° Elbow BSPT male-BSPT male forge
Adattatore a 90° maschio-maschio BSPT forgiato

ROSCA THREAD		REFERENCIA PART N°	€
1/4" BSPT	1/4" BSPT	S119504	5,53
3/8" BSPT	3/8" BSPT	S119506	6,89
1/2" BSPT	1/2" BSPT	S119508	10,78
3/4" BSPT	3/4" BSPT	S119512	12,92
1" BSPT	1" BSPT	S119516	24,71

Adaptadores BSP

Adapteurs BSP
BSP Adaptors
Adattatori BSP

Codo 90° macho BSP (60°) -macho BSP regulable forja



Adapteur coude 90° mâle BSP x mâle gaz cyl orientable or + bae en forge
90° Elbow BSP male-BSP male adjustable forge
Adattatore a 90° maschio BSP 60° - maschio BSP regolabile forgiato

ROSCA THREAD		REFERENCIA PART N°	€
M 1/4" BSP	MR 1/4" BSP	S11970404	2,89
M 3/8" BSP	MR 1/4" BSP	S11970604	4,26
M 3/8" BSP	MR 3/8" BSP	S11970606	3,97
M 1/2" BSP	MR 3/8" BSP	S11970806	4,41
M 1/2" BSP	MR 1/2" BSP	S11970808	5,13
M 3/4" BSP	MR 1/2" BSP	S11971208	8,96
M 3/4" BSP	MR 3/4" BSP	S11971212	9,17
M 1" BSP	MR 3/4" BSP	S11971612	15,24
M 1" BSP	MR 1" BSP	S11971616	12,57
M 1 1/4" BSP	MR 1 1/4" BSP	S11972020	23,69

Codo 45° macho BSP (60°) -macho BSP regulable forja

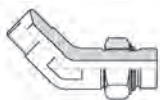

Adapteur coude 45° mâle BSP x mâle gaz cyl orientable or + bae en forge
45° Elbow BSP male-BSP male adjustable forge
Adattatore a 45° maschio BSP 60° - maschio BSP regolabile forgiato

ROSCA THREAD		REFERENCIA PART N°	€
M 1/4" BSP	MR 1/4" BSP	S11980404	3,11
M 3/8" BSP	MR 3/8" BSP	S11980606	5,84
M 1/2" BSP	MR 1/2" BSP	S11980808	6,86
M 3/4" BSP	MR 3/4" BSP	S11981212	7,80
M 1" BSP	MR 1" BSP	S11981616	14,16

Codo 90° macho-hembra giratoria BSP (60°) forja



Adapteur coude 90° mâle BSP x femelle tournante BSP (60°) forge
90° Elbow BSP male-BSP swivel female forge
Adattatore a 90° maschio-femmina girevole BSP (60°) forgiato

ROSCA THREAD		REFERENCIA PART N°	€
1/4" BSP	1/4" BSP	S119304	3,03
3/8" BSP	3/8" BSP	S119306	4,12
1/2" BSP	1/2" BSP	S119308	5,20
3/4" BSP	3/4" BSP	S119312	7,37
1" BSP	1" BSP	S119316	11,63
1 1/4" BSP	1 1/4" BSP	S119320	18,49
1 1/2" BSP	1 1/2" BSP	S119324	38,57

Codo 90° macho BSPT- hembra giratoria BSP (60°) forja



Adapteur coude 90° mâle gaz conique (BSPT) x femelle tournante BSP (60°) forge
90° Elbow BSPT male-BSP swivel female (60°) forge
Adattatore a 90° maschio BSPT - femmina girevole BSP 60° forgiato

ROSCA THREAD		REFERENCIA PART N°	€
M 1/4" BSPT	H 1/4" BSP	S119904	7,49
M 3/8" BSPT	H 3/8" BSP	S119906	9,43
M 1/2" BSPT	H 1/2" BSP	S119908	12,29
M 3/4" BSPT	H 3/4" BSP	S119912	18,43
M 1" BSPT	H 1" BSP	S119916	29,90

Codo 90° macho BSPT- hembra fija BSP forja



Adapteur coude 90° mâle gaz conique (BSPT) x femelle gaz conique (BSP) forge
90° Elbow BSPT male-BSP fixed female forge
Adattatore a 90° maschio BSPT - femmina fissa BSP (60°) forgiato

ROSCA THREAD		REFERENCIA PART N°	€
M 1/8" BSPT	H 1/8" BSP	S119402	2,53
M 1/4" BSPT	H 1/4" BSP	S119404	3,61
M 3/8" BSPT	H 3/8" BSP	S119406	4,17
M 1/2" BSPT	H 1/2" BSP	S119408	4,77
M 3/4" BSPT	H 3/4" BSP	S119412	8,81
M 1" BSPT	H 1" BSP	S119416	12,35

Codo 90° hembra fija- hembra fija BSP forja

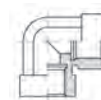

Adapteur coude 90° femelle fixe gaz cyl forge
90° Elbow BSP fixed female-BSP fixed female forge
Adattatore a 90° maschio BSPT - femmina fissa BSP forgiato

ROSCA THREAD		REFERENCIA PART N°	€
1/8" BSP	1/8" BSP	S119602	2,60
1/4" BSP	1/4" BSP	S119604	3,18
3/8" BSP	3/8" BSP	S119606	3,97
1/2" BSP	1/2" BSP	S119608	6,21
3/4" BSP	3/4" BSP	S119612	9,39
1" BSP	1" BSP	S119616	14,09
1 1/4" BSP	1 1/4" BSP	S119620	40,23

Codo 45° macho-hembra giratoria forja BSP 60°



Adapteur coude 45° mâle-femelle tournante BSP forge
45° Elbow BSP male-BSP swivel female forge
Adattatore a 45° maschio-femmina girevole BSP forgiato

ROSCA THREAD		REFERENCIA PART N°	€
1/4" BSP	1/4" BSP	S118504	2,82
3/8" BSP	3/8" BSP	S118506	3,40
1/2" BSP	1/2" BSP	S118508	4,70
3/4" BSP	3/4" BSP	S118512	7,08
1" BSP	1" BSP	S118516	10,91
1 1/4" BSP	1 1/4" BSP	S118520	19,86

Codo macho-macho Métrico (60°)



Adapteur coude 90° mâle Métrique x mâle Métrique (60°)
90° Elbow Metric adaptor male-male (60°)
Adattatore a 90° maschio-maschio Metrico

ROSCA THREAD		REFERENCIA PART N°	€
M12x1.5	M12x1.5	S86012	6,14
M16x1.5	M16x1.5	S86016	7,57
M22x1.5	M22x1.5	S86022	15,25

Adaptadores BSP

Adapteurs BSP
BSP Adaptors
Adattatori BSP

Te macho-macho-macho BSP forja

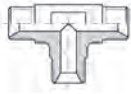

Adapteur Té mâle BSP x mâle BSP x mâle BSP (60°) forge
Tee BSP Male (60°) forja
Adattatore a T maschio BSP (60°) forgiato

ROSCA THREAD			REFERENCIA PART N°	€
1/4" BSP	1/4" BSP	1/4" BSP	S122004	2,60
3/8" BSP	3/8" BSP	3/8" BSP	S122006	3,32
1/2" BSP	1/2" BSP	1/2" BSP	S122008	4,70
3/4" BSP	3/4" BSP	3/4" BSP	S122012	6,07
1" BSP	1" BSP	1" BSP	S122016	11,20
1"1/4 BSP	1"1/4 BSP	1"1/4 BSP	S122020	33,37

Te macho-macho-hembra giratoria BSP (60°) forja

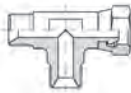

Adapteur Té mâle BSP x mâle BSP x femelle tournante BSP (60°) forge
Tee BSP Male-male-swivel female (60°) forja
Adattatore a T maschio-maschio-femmine girevole BSP forgiato

ROSCA THREAD			REFERENCIA PART N°	€
1/4" BSP	1/4" BSP	1/4" BSP	S122304	3,11
3/8" BSP	3/8" BSP	3/8" BSP	S122306	3,97
1/2" BSP	1/2" BSP	1/2" BSP	S122308	5,63
3/4" BSP	3/4" BSP	3/4" BSP	S122312	9,61
1" BSP	1" BSP	1" BSP	S122316	14,88
1"1/4 BSP	1"1/4 BSP	1"1/4 BSP	S122320	21,89

Te macho-hembra giratoria- macho BSP (60°) forja

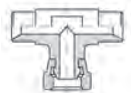

Adapteur Té mâle BSP x femelle tournante BSP x mâle BSP (60°) forge
Tee BSP Male-swivel female-male (60°) forja
Adattatore a T maschio-femmina girevole-maschio BSP forgiato

ROSCA THREAD			REFERENCIA PART N°	€
1/4" BSP	1/4" BSP	1/4" BSP	S122404	3,11
3/8" BSP	3/8" BSP	3/8" BSP	S122406	3,97
1/2" BSP	1/2" BSP	1/2" BSP	S122408	5,63
3/4" BSP	3/4" BSP	3/4" BSP	S122412	9,61
1" BSP	1" BSP	1" BSP	S122416	14,88
1"1/4 BSP	1"1/4 BSP	1"1/4 BSP	S122420	22,83

Te hembras giratorias BSP (60°) forja

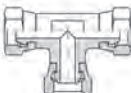

Adapteur Té femelle tournante BSP (60°) forge
Tee BSP Swivel female (60°) forja
Adattatore a T femmina girevole BSP forgiato

ROSCA THREAD			REFERENCIA PART N°	€
1/4" BSP	1/4" BSP	1/4" BSP	S122504	6,07
3/8" BSP	3/8" BSP	3/8" BSP	S122506	7,15
1/2" BSP	1/2" BSP	1/2" BSP	S122508	8,31
3/4" BSP	3/4" BSP	3/4" BSP	S122512	14,59
1" BSP	1" BSP	1" BSP	S122516	23,91

Te hembras fijas BSP forja

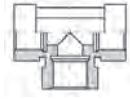

Adapteur Té femelle fixe gaz (BSP) forge
Tee BSP fixed female forja
Adattatore a T femmina fissa BSP

ROSCA THREAD			REFERENCIA PART N°	€
1/8" BSP	1/8" BSP	1/8" BSP	S122602	3,18
1/4" BSP	1/4" BSP	1/4" BSP	S122604	3,83
3/8" BSP	3/8" BSP	3/8" BSP	S122606	5,27
1/2" BSP	1/2" BSP	1/2" BSP	S122608	6,50
3/4" BSP	3/4" BSP	3/4" BSP	S122612	11,20
1" BSP	1" BSP	1" BSP	S122616	20,73
1"1/4 BSP	1"1/4 BSP	1"1/4 BSP	S122620	66,67

Te macho-macho-macho regulable lateral BSP forja

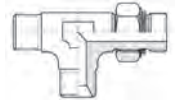

Adapteur Té égal orientable latéral mâle BSP (60°) x mâle BSP (60°) x mâle gaz cyl or + bae forge
Tee BSP male-male-male lateral adjustable forja
Adattatore a T maschio-maschio-maschio orientabile laterale BSP

ROSCA THREAD			REFERENCIA PART N°	€
1/4" BSP	1/4" BSP	MR 1/4" BSP	S12290404	11,86
3/8" BSP	3/8" BSP	MR 3/8" BSP	S12290606	17,24
1/2" BSP	1/2" BSP	MR 3/8" BSP	S12290806	24,68
1/2" BSP	1/2" BSP	MR 1/2" BSP	S12290808	24,68
3/4" BSP	3/4" BSP	MR 1/2" BSP	S12291208	34,67
3/4" BSP	3/4" BSP	MR 3/4" BSP	S12291212	34,67
1" BSP	1" BSP	MR 3/4" BSP	S12291612	45,97
1" BSP	1" BSP	MR 1" BSP	S12291616	45,97
1"1/4 BSP	1"1/4 BSP	MR 1"1/4 BSP	S12292020	60,30

Te macho-macho regulable central-macho BSP forja

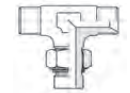

Adapteur Té égal orientable central mâle BSP (60°) x mâle gaz cyl or + bae x mâle BSP (60°) forge
Tee BSP male-male central adjustable-BSP male forja
Adattatore a T maschio-maschio-maschio orientabile centrale BSP forgiato

ROSCA THREAD			REFERENCIA PART N°	€
1/4" BSP	MR 1/4" BSP	1/4" BSP	S12280404	11,86
3/8" BSP	MR 1/4" BSP	3/8" BSP	S12280604	26,62
3/8" BSP	MR 3/8" BSP	3/8" BSP	S12280606	17,24
1/2" BSP	MR 3/8" BSP	1/2" BSP	S12280806	31,36
1/2" BSP	MR 1/2" BSP	1/2" BSP	S12280808	24,68
3/4" BSP	MR 3/4" BSP	1/2" BSP	S12281208	40,12
3/4" BSP	MR 3/4" BSP	3/4" BSP	S12281212	34,43
1" BSP	MR 3/4" BSP	1" BSP	S12281612	53,55
1" BSP	MR 1" BSP	1" BSP	S12281616	45,97
1"1/4 BSP	MR 1" BSP	1"1/4 BSP	S12282016	60,30
1"1/4 BSP	MR 1"1/4 BSP	1"1/4 BSP	S12282020	70,95

Adaptadores BSP

Adapteurs BSP
BSP Adaptors
Adattatori BSP

Te macho-macho-macho Métrica (60°)



Adapteur Té égal mâle x mâle x mâle Métrique (60°)

Tee Metric male (60°)

Adattatore a T maschio-maschio-maschio Metrico

ROSCA THREAD			REFERENCIA PART N°	€
M16x1.5	M16x1.5	M16x1.5	S86516	9,96
M18x1.5	M18x1.5	M18x1.5	S86518	10,75
M20x1.5	M20x1.5	M20x1.5	S86520	13,00
M22x1.5	M22x1.5	M22x1.5	S86522	13,00
M26x1.5	M26x1.5	M26x1.5	S86526	21,24
M30x1.5	M30x1.5	M30x1.5	S86530	28,18

Codo 90° reductor macho- macho cuadrado BSP (60°)



Adapteur coude 90° reducteur mâle BSP x mâle BSP (60°) en bloque

90° reducer elbow male-bsp male (60°) (square)

Adattatore a 90° maschio-maschio quadrato BSP (60°)

ROSCA THREAD		REFERENCIA PART N°	€
1/8" BSP	1/4" BSP	A11920204	4,42
1/4" BSP	3/8" BSP	A11920406	5,44
3/8" BSP	1/2" BSP	A11920608	8,00
1/2" BSP	3/4" BSP	A11920812	10,94
3/4" BSP	1" BSP	A11921216	25,62

TE macho-macho-macho bloque

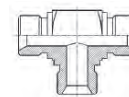

Adapteur Té mâle BSP x mâle BSP x mâle BSP

Tee BSP male (square)

Adattatore a T maschio quadrato BSP 60°

ROSCA THREAD			REFERENCIA PART N°	€
1/4" BSP	1/4" BSP	1/4" BSP	A22200400	3,47
3/8" BSP	3/8" BSP	3/8" BSP	A22200600	4,41
1/2" BSP	1/2" BSP	1/2" BSP	A22200800	6,14
3/4" BSP	3/4" BSP	3/4" BSP	A22201200	8,74
1" BSP	1" BSP	1" BSP	A22201600	19,07

Codo 90° macho BSP bloque



Adapteur Coude 90° mâle BSP

90° Elbow BSP male (square)

Adattatore a 90° maschio-maschio quadrato BSP (60°)

ROSCA THREAD		REFERENCIA PART N°	€
1/4" BSP	1/4" BSP	A21900400	2,60
3/8" BSP	3/8" BSP	A21900600	2,96
1/2" BSP	1/2" BSP	A21900800	4,26
3/4" BSP	3/4" BSP	A21901200	6,36
1" BSP	1" BSP	A21901600	12,28

TE macho-tuerca loca- macho bloque

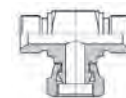

Adapteur Té mâle BSP x femelle tournante BSP x mâle BSP

Tee BSP male-swivel female-male (square)

Adattatore a T maschio-femmina girevole-maschio quadrato BSP (60°)

ROSCA THREAD			REFERENCIA PART N°	€
1/4" BSP	1/4" BSP	1/4" BSP	A22240400	3,61
3/8" BSP	3/8" BSP	3/8" BSP	A22240600	4,77
1/2" BSP	1/2" BSP	1/2" BSP	A22240800	6,72
3/4" BSP	3/4" BSP	3/4" BSP	A22241200	9,25
1" BSP	1" BSP	1" BSP	A22241600	17,70

Codo 90° macho-hembra giratoria bloque



Adapteur Coude 90° mâle BSP x femelle BSP

90° Elbow BSP male-BSP swivel female (square)

Adattatore a 90° maschio-femmina girevole quadrato BSP (60°)

ROSCA THREAD		REFERENCIA PART N°	€
1/4" BSP	1/4" BSP	A21930400	3,54
3/8" BSP	3/8" BSP	A21930600	3,76
1/2" BSP	1/2" BSP	A21930800	6,00
3/4" BSP	3/4" BSP	A21931200	7,22
1" BSP	1" BSP	A21931600	23,91

TE macho-macho-tuerca loca bloque

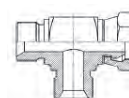

Adapteur Té mâle BSP x mâle BSP x femelle tournante BSP

Tee BSP male-male-swivel female (square)

Adattatore a T maschio-maschio-femmina girevole quadrato BSP

ROSCA THREAD			REFERENCIA PART N°	€
1/4" BSP	1/4" BSP	1/4" BSP	A22220400	3,61
3/8" BSP	3/8" BSP	3/8" BSP	A22220600	4,77
1/2" BSP	1/2" BSP	1/2" BSP	A22220800	6,72
3/4" BSP	3/4" BSP	3/4" BSP	A22221200	14,37
1" BSP	1" BSP	1" BSP	A22221600	17,70

Adaptadores BSP

Adaptateurs BSP
BSP Adaptors
Adattatori BSP

Cruz macho BSP bloque



Adaptateur Croix égale mâle BSP

Cross BSP male (square)

Croce maschio BSP 60°

ROSCA THREAD	REFERENCIA PART N°	€
1/4" BSP	A22230400	4,13
3/8" BSP	A22230600	3,80
1/2" BSP	A22230800	7,48
3/4" BSP	A22231200	18,23
1" BSP	A22231600	13,59

Juntas Metal Buna GAS Autocentrantes



Bague BS Gaz

BSP Bonded Seal

Rondelle Bonded GAS

ROSCA THREAD	REFERENCIA PART N°	€
1/8" BSP	T21002	0,23
1/4" BSP	T21004	0,24
3/8" BSP	T21006	0,29
1/2" BSP	T21008	0,34
5/8" BSP	T21010	0,44
3/4" BSP	T21012	0,40
1" BSP	T21016	0,70
1"1/4 BSP	T21020	1,09
1"1/2 BSP	T21024	1,23
2" BSP	T21032	1,89

Se venden en bolsas, consultar cantidades // Vendu dans des sacs, demandez la quantité // Sold in bags, ask for quantity // Venduti in sacchetti, chiedere per la quantità

Juntas Metal Buna Métricas Autocentrantes



Bague BS Métrique

Metric Bonded Seal

Rondelle Bonded Metriche

ROSCA THREAD	REFERENCIA PART N°	€
M8x1	T32008	0,24
M10x1	T32010	0,24
M12x1.5	T32012	0,26
M14x1.5	T32014	0,29
M16x1.5	T32016	0,31
M18x1.5	T32018	0,33
M20x1.5	T32020	0,35
M22x1.5	T32022	0,38
M24x1.5	T32024	0,39
M26x1.5	T32026	0,60
M30x2	T32030	0,70
M32x2	T32032	*
M36x2	T32036	1,03
M42x2	T32042	1,75

Se venden en bolsas, consultar cantidades // Vendu dans des sacs, demandez la quantité // Sold in bags, ask for quantity // Venduti in sacchetti, chiedere per la quantità

Arandelas Aluminio GAS



Rondelle Gaz Aluminium

BSP Aluminium Collar Plate

Rondella in Alluminio GAS

ROSCA THREAD	REFERENCIA PART N°	€
1/8"	A133202	0,08
1/4"	A133204	0,12
3/8"	A133206	0,15
1/2"	A133208	0,23
3/4"	A133212	0,35
1"	A133216	0,47
1"1/4	A133220	0,70
1"1/2	A133224	0,81

Arandelas plana Cobre recocido GAS



Rondelle plane Gaz Cuivre recuit

Annealed Copper flat Plate

Rondella in Rame

ROSCA THREAD	REFERENCIA PART N°	€
1/8"	A133002	0,18
1/4"	A133004	0,28
3/8"	A133006	0,30
1/2"	A133008	0,45
3/4"	A133012	0,85
1"	A133016	1,90
1"1/4	A133020	2,96
1"1/2	A133024	4,29
2"	A133032	7,30

Artículos bajo consulta

Articles à consulter | Items on request | Articoli su richiesta

S1180

Codo 45° macho-macho BSP (60°) forja | Adapteur coude 45° mâle BSP (60°)x mâle BSP (60°) forge | 45° elbow male bsp-male bsp (60°) forge | Adattatore a 45° maschio-maschio BSP (60°) forgiato

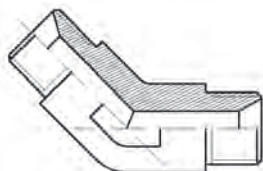

S1182

Codo 45° macho BSP (60°) -macho BSPT forja | Adapteur coude 45° mâle BSP (60°)x mâle BSPT forge | 45° Elbow BSP male (60°)-BSPT male forge | Adattatore a 45° maschio BSP (60°) - maschio BSPT forgiato

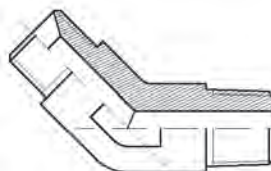

S1183

Codo 90° hembra giratoria-hembra giratoria BSP (60°) forja | Adapteur coude 90° femelle tournante BSP (60°) forge | 90° Elbow BSP (60°) swivel female-BSP (60°) swivel female forge | Adattatore a 90° femmina girevole-femmina girevole BSP (60°) forgiato

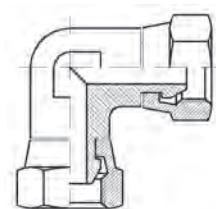

S1184

Codo 90° macho BSPT-hembra giratoria BSP (60°) forja | Adapteur coude 90° mâle BSPT x femelle tournante BSP (60°) forge | 90° Elbow BSPT male-BSP (60°) swivel female forge | Adattatore a 90° maschio BSPT-femmina girevole BSP (60°) forgiato

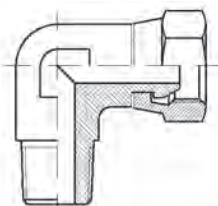

S1186

Codo 45° hembra fija-hembra fija BSP (60°) forja | Adapteur coude 45° femelle fixe BSP (60°) forge | 45° Elbow BSP (60°) fixed female-BSP (60°) fixed female forge | Adattatore a 45° femmina fissa-femmina fissa BSP (60°) forgiato

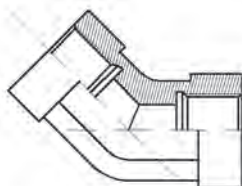

S1281

Te macho BSP (60°)-macho BSPT-macho BSP (60°) forja | Adapteur Té mâle BSP (60°)x mâle BSPT x mâle BSP (60°) forge | Tee BSP (60°) male-BSPT male-BSP (60°) male forge | Adattatore a T maschio BSP (60°)-maschio BSPT-maschio BSP (60°) forgiato

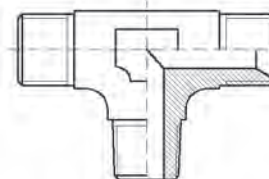

S1282

Te macho BSP (60°)-macho BSP (60°)-macho BSPT forja | Adapteur Té mâle BSP (60°) x mâle BSP (60°) x mâle BSPT forge | Tee BSP male (60°)-BSP male (60°)-BSPT male forge | Adattatore a T maschio BSP (60°)-maschio BSP (60°)-maschio BSPT forgiato

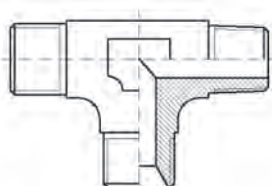

Accesorios ORFS

Accessoires ORFS
ORFS Accessories
Accessori ORFS

2

Accesorios ORFS
Accessoires ORFS | ORFS | ORFS

216

Accesorios ORFS

Accessoires ORFS | ORFS | ORFS

Adaptors

ORFS

Quick-release couplings

Ball valves, diverters

Protections

▶ **ORFS Rectos** | ORFS Droïts | Straight ORFS | Raccordi diritti ORFS

217



OR102



OR104



OR200

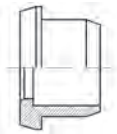

OR1273

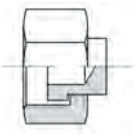

OR105



OR202



OR302

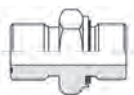

OR1017

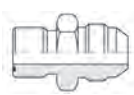

OR204

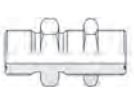

OR106

▶ **Codos 45° ORFS** | Coude 45° ORFS | ORFS 45° Elbows | Raccordi a 45° ORFS

219



OR501



OR601

▶ **Codos 90° ORFS** | Coude 90° ORFS | ORFS 90° Elbows | Raccordi a 90° ORFS

219



OR405



OR600



OR403



OR401

▶ **Te ORFS** | Tés ORFS | ORFS Tees | Raccordi a T ORFS

220

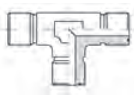

OR700



OR701



OR702

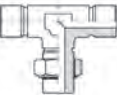

OR703

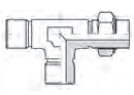

OR704

Accesorios ORFS

Accessoires ORFS
ORFS
ORFS

Tuerca ORFS



Ecrou ORFS
ORFS Nut
Dado ORFS

TUBO PIPE	ROSCA THREAD	REFERENCIA PART N°	€
6-8	ORFS 9/16"-18h	OR1020400	0,85
10	ORFS 11/16"-16h	OR1020600	1,05
12	ORFS 13/16"-16h	OR1020800	1,22
14-15-16	ORFS 1"-14h	OR1021000	1,65
18-20	ORFS 1"3/16-12h	OR1021200	4,49
22-25	ORFS 1"7/16-12h	OR1021600	4,92
28-30-32	ORFS 1"11/16-12h	OR1022000	9,13
35-38	ORFS 2"-12h	OR1022400	10,65

Tapón macho ORFS



Bouchon mâle ORFS
ORFS Male plug
Tappo maschio ORFS

ROSCA THREAD	REFERENCIA PART N°	€
ORFS 9/16"-18h	OR1040400	1,23
ORFS 11/16"-16h	OR1040600	1,52
ORFS 13/16"-16h	OR1040800	1,88
ORFS 1"-14h	OR1041000	2,38
ORFS 1"3/16-12h	OR1041200	3,47
ORFS 1"7/16-12h	OR1041600	5,20
ORFS 1"11/16-12h	OR1042000	7,22
ORFS 2"-12h	OR1042400	14,16

Adaptador macho ORFS

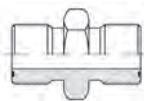

Mâle ORFS-ORFS
ORFS-ORFS Male
Adattatore maschio ORFS

ROSCA THREAD	REFERENCIA PART N°	€	
ORFS 9/16"-18h	ORFS 9/16"-18h	OR2000404	2,02
ORFS 11/16"-16h	ORFS 9/16"-18h	OR2000604	2,09
ORFS 11/16"-16h	ORFS 11/16"-16h	OR2000606	2,53
ORFS 13/16"-16h	ORFS 11/16"-16h	OR2000806	3,11
ORFS 13/16"-12h	ORFS 13/16"-16h	OR2000808	3,11
ORFS 1"-14h	ORFS 13/16"-16h	OR2001008	3,97
ORFS 1"-14h	ORFS 1"-14h	OR2001010	4,05
ORFS 1" 3/16-12h	ORFS 1"-14h	OR2001210	4,55
ORFS 1"3/16-12h	ORFS 1"3/16-12h	OR2001212	10,86
ORFS 1"7/16-12h	ORFS 1"3/16-12h	OR2001612	24,75
ORFS 1"7/16-12h	ORFS 1"7/16-12h	OR2001616	13,03
ORFS 1"11/16-12h	ORFS 1"7/16-12h	OR2002016	19,43
ORFS 1"11/16-12h	ORFS 1"11/16-12h	OR2002020	19,14
ORFS 2"-12h	ORFS 2"-12h	OR2002424	22,32

Cono soldar



Collet à souder ORFS
ORFS Welding cone
Ogiva a saldare ORFS

TUBO PIPE	ROSCA THREAD	REFERENCIA PART N°	€
6	ORFS 9/16"-18h	OR12730406	0,88
8	ORFS 9/16"-18h	OR12730408	1,27
10	ORFS 11/16"-16h	OR12730610	1,54
12	ORFS 13/16"-16h	OR12730812	0,99
14	ORFS 1"-14h	OR12731014	1,27
15	ORFS 1"-14h	OR12731015	1,27
16	ORFS 1"-14h	OR12731016	1,27
18	ORFS 1" 3/16-12h	OR12731218	1,49
20	ORFS 1" 3/16-12h	OR12731220	2,28
22	ORFS 1" 7/16-12h	OR12731622	3,96
30	ORFS 1"11/16-12h	OR12732030	7,28
32	ORFS 1"11/16-12h	OR12732032	7,28
38	ORFS 2"-12h	OR12732438	8,24

Tapón hembra ORFS



Bouchon femelle ORFS
ORFS Female plug
Tappo femmina ORFS

ROSCA THREAD	REFERENCIA PART N°	€
ORFS 9/16"-18h	OR1050400	1,30
ORFS 11/16"-16h	OR1050600	1,73
ORFS 13/16"-16h	OR1050800	2,09
ORFS 1"-14h	OR1051000	3,11
ORFS 1"3/16-12h	OR1051200	4,19
ORFS 1"7/16-12h	OR1051600	5,49
ORFS 1"11/16-12h	OR1052000	11,85
ORFS 2"-12h	OR1052400	20,23

Adaptador macho ORFS-BSP

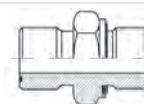

Mâle ORFS-BSP
ORFS-BSP Male
Adattatore maschio ORFS-BSP

ROSCA THREAD	REFERENCIA PART N°	€	
ORFS 9/16"-18h	ORFS 9/16"	OR2020402	1,60
ORFS 9/16"-18h	BSP 1/4"	OR2020404	1,71
ORFS 11/16"-16h	BSP 1/4"	OR2020604	3,14
ORFS 11/16"-16h	BSP 3/8"	OR2020606	3,17
ORFS 13/16"-16h	BSP 3/8"	OR2020806	3,44
ORFS 13/16"-16h	BSP 1/2"	OR2020808	4,74
ORFS 1"-14h	BSP 1/2"	OR2021008	3,47
ORFS 1"3/16-12h	BSP 3/4"	OR2021212	7,28
ORFS 1"7/16-12h	BSP 1"	OR2021616	10,03
ORFS 1"11/16-12h	BSP 1" 1/4"	OR2022020	20,95
ORFS 2"-12h	BSP 1" 1/2"	OR2022424	34,75

Accesorios ORFS

Accessoires ORFS
ORFS
ORFS

Adaptors

Adaptador macho ORFS-hembra giratoria JIC

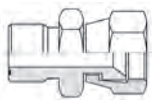

Mâle ORFS-femelle tournante JIC
ORFS Male-JIC Swivel female
Adattatore maschio ORFS-femmina girevole JIC

ROSCA THREAD		REFERENCIA PART N°	€
ORFS 9/16"-18h	JIC 7/16"	OR3020404	3,22
ORFS 11/16"-16h	JIC 9/16"	OR3020606	3,80
ORFS 13/16"-16h	JIC 3/4"	OR3020808	6,99
ORFS 1"-14h	JIC 7/8"	OR3021010	7,43
ORFS 1"3/16-12h	JIC 1" 1/16	OR3021212	8,58
ORFS 1"7/16-12h	JIC 1" 5/16	OR3021616	12,16
ORFS 1"11/16-12h	JIC 1" 5/8	OR3022020	18,81

Adaptador macho ORFS-JIC

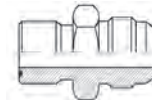

Mâle ORFS-JIC
ORFS-JIC Male
Adattatore maschio ORFS-JIC

ROSCA THREAD		REFERENCIA PART N°	€
ORFS 9/16"-18h	JIC 7/16"	OR2040404	3,74
ORFS 11/16"-16h	JIC 9/16"	OR2040606	2,67
ORFS 13/16"-16h	JIC 3/4"	OR2040808	2,84
ORFS 1"-14h	JIC 7/8"	OR2041010	4,44
ORFS 1"3/16-12h	JIC 1" 1/16	OR2041212	8,78
ORFS 1"7/16-12h	JIC 1" 5/16	OR2041616	9,31

Macho ORFS-Métrico

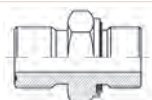

Mâle ORFS Métrique
Metric ORFS Male
Maschio ORFS Metrico

ROSCA THREAD		REFERENCIA PART N°	€
ORFS 9/16"-18h	M12x1.5	OR10170412	4,98
ORFS 11/16"-16h	M16x1.5	OR10170616	5,27
ORFS 13/16"-16h	M18x1.5	OR10170818	4,13
ORFS 1"-14h	M22x1.5	OR10171022	5,35
ORFS 1"7/16-12h	M33x2	OR10171633	11,07
ORFS 1"11/16-12h	M42x2	OR10172042	20,89
ORFS 2"-12h	M48x2	OR10172448	32,60

Pasatabiques ORFS



Passe-cloison ORFS
ORFS Bulkhead
Passaparete ORFS

ROSCA THREAD	REFERENCIA PART N°	€
ORFS 9/16"-18h	OR1060404	3,08
ORFS 11/16"-16h	OR1060606	29,76
ORFS 13/16"-16h	OR1060808	13,72
ORFS 1"-14h	OR1061010	7,98
ORFS 1"3/16-12h	OR1061212	18,56
ORFS 1"7/16-12h	OR1061616	15,35
ORFS 1"11/16-12h	OR1062020	37,76
ORFS 2"-12h	OR1062424	54,08

Quick-release couplings

Ball valves, diverters

Protections

Accesorios ORFS

Accessoires ORFS
ORFS
ORFS

Codo 45° regulable ORFS-BSP

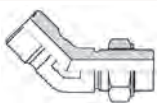

Coude 45° mâle ORFS-mâle gaz cyl. or+jo+bae
Adjustable 45° elbow ORFS male-BSP male
Raccordo a 45° orientabile ORFS-BSP

ROSCA THREAD	REFERENCIA PART N°	€
ORFS 9/16"-18h	BSP 1/8"	OR5010402 4,48
ORFS 9/16"-18h	BSP 1/4"	OR5010404 4,70
ORFS 11/16"-16h	BSP 1/4"	OR5010604 5,35
ORFS 11/16"-16h	BSP 3/8"	OR5010606 6,00
ORFS 11/16"-16h	BSP 1/2"	OR5010608 7,15
ORFS 13/16"-16h	BSP 3/8"	OR5010806 8,09
ORFS 1"-14h	BSP 1/2"	OR5011008 9,90
ORFS 1"-14h	BSP 3/4"	OR5011012 12,64
ORFS 1"3/16-12h	BSP 3/4"	OR5011212 13,36
ORFS 1"3/16-12h	BSP 1"	OR5011216 19,36
ORFS 1"7/16-12h	BSP 1"	OR5011616 20,88

Codo 45° regulable hembra giratoria ORFS

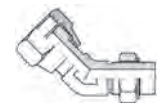

Coude 45° mâle ORFS-femelle tournante ORFS
Adjustable 45° elbow ORFS swivel female-ORFS male
Raccordo a 45° orientabile maschio-femmina girevole ORFS

ROSCA THREAD	REFERENCIA PART N°	€
ORFS 9/16"-18h	ORFS 9/16"-18h	OR6010404 5,20
ORFS 11/16"-16h	ORFS 11/16"-16h	OR6010606 6,57
ORFS 13/16"-16h	ORFS 13/16"-16h	OR6010808 7,95
ORFS 1"-14h	ORFS 1"-14h	OR6011010 9,82
ORFS 1"3/16-12h	ORFS 1"3/16-12h	OR6011212 14,37
ORFS 1"7/16-12h	ORFS 1"7/16-12h	OR6011616 24,20
ORFS 1" 11/16	ORFS 1" 11/16	OR6012020 32,87
ORFS 2"-12h	ORFS 2"-12h	OR6012424 38,43

Codo 90° ORFS-ORFS



Coude 90° mâle ORFS-mâle ORFS
90° Elbow ORFS male-ORFS male
Raccordo a 90° ORFS-ORFS

ROSCA THREAD	REFERENCIA PART N°	€
ORFS 9/16"-18h	ORFS 9/16"-18h	OR4050404 7,20
ORFS 11/16"-16h	ORFS 11/16"-16h	OR4050606 7,68
ORFS 13/16"-16h	ORFS 13/16"-16h	OR4050808 9,38
ORFS 1"-14h	ORFS 1"-14h	OR4051010 11,92
ORFS 1"3/16-12h	ORFS 1"3/16-12h	OR4051212 14,04
ORFS 1"7/16-12h	ORFS 1"7/16-12h	OR4051616 42,21
ORFS 1"11/16-12h	ORFS 1"11/16-12h	OR4052020 41,05
ORFS 2"-12h	ORFS 2"-12h	OR4052424 50,93

Codo 90° pasatabique ORFS

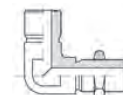

Coude 90° passe-cloison ORFS
90° Elbow ORFS Bulkhead
Raccordo a 90° passaparete ORFS

ROSCA THREAD	REFERENCIA PART N°	€
ORFS 9/16"-18h	ORFS 9/16"-18h	OR4030404 13,45
ORFS 11/16"-16h	ORFS 11/16"-16h	OR4030606 18,49
ORFS 1"-14h	ORFS 1"-14h	OR4031010 23,89
ORFS 1"3/16-12h	ORFS 1"3/16-12h	OR4031212 29,50
ORFS 1"7/16-12h	ORFS 1"7/16-12h	OR4031616 51,56
ORFS 1"11/16-12h	ORFS 1"11/16-12h	OR4032020 59,59
ORFS 2"-12h	ORFS 2"-12h	OR4032424 80,51

Codo 90° regulable ORFS-BSP



Coude 90° mâle ORFS + mâle gaz cyl. or+JO+BAE
Adjustable 90° elbow ORFS male -BSP male
Raccordo a 90° regolabile ORFS-BSP

ROSCA THREAD	REFERENCIA PART N°	€
ORFS 9/16"-18h	BSP 1/8"	OR4010402 9,69
ORFS 9/16"-18h	BSP 1/4"	OR4010404 9,56
ORFS 9/16"-18h	BSP 3/8"	OR4010406 16,68
ORFS 11/16"-16h	BSP 1/4"	OR4010604 8,95
ORFS 11/16"-16h	BSP 3/8"	OR4010606 9,98
ORFS 13/16"-16h	BSP 1/4"	OR4010804 10,12
ORFS 13/16"-16h	BSP 1/2"	OR4010808 12,66
ORFS 1"-14h	BSP 3/8"	OR4011006 13,51
ORFS 1"-14h	BSP 1/2"	OR4011008 13,19
ORFS 1"3/16-12h	BSP 1/2"	OR4011208 16,68
ORFS 1"3/16-12h	BSP 3/4"	OR4011212 17,56
ORFS 1"3/16-12h	BSP 1"	OR4011216 37,23
ORFS 1"7/16-12h	BSP 1"	OR4011616 35,50
ORFS 1"7/16-12h	BSP 1" 1/4	OR4011620 49,07
ORFS 1"11/16-12h	BSP 1"	OR4012016 42,43
ORFS 1"11/16-12h	BSP 1" 1/4	OR4012020 49,07
ORFS 2"-12h	BSP 1" 1/2	OR4012424 62,71

Codo 90° macho-hembra giratoria ORFS



Coude 90° femelle tournantet-mâle ORFS
90° Elbow ORFS Swivel female-ORFS male
Raccordo a 90° maschio-femmina girevole ORFS

ROSCA THREAD	REFERENCIA PART N°	€
ORFS 9/16"-18h	OR6000404	10,33
ORFS 11/16"-16h	OR6000606	11,50
ORFS 13/16"-16h	OR6000808	12,85
ORFS 1"-14h	OR6001010	15,69
ORFS 1"3/16-12h	OR6001212	20,61
ORFS 1"7/16-12h	OR6001616	33,78
ORFS 1"11/16-12h	OR6002020	62,47

Accesorios ORFS

Accessoires ORFS
ORFS
ORFS

Adaptors

TE Macho ORFS

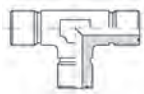

Té Égal mâle ORFS

Tee ORFS male

Raccordo a T maschio ORFS

ROSCA THREAD	REFERENCIA PART N°	€
ORFS 9/16"-18h	OR7000404	8,32
ORFS 11/16"-16h	OR7000606	10,86
ORFS 13/16"-16h	OR7000808	13,80
ORFS 1"-14h	OR7001010	15,41
ORFS 1"3/16-12h	OR7001212	16,90
ORFS 1"7/16-12h	OR7001616	40,41
ORFS 1"11/16-12h	OR7002020	42,32
ORFS 2"-12h	OR7002424	75,37

TE Regulable ORFS-BSP Central

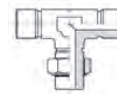

Té mâle ORFS-mâle ORFS-mâle gaz cyl+or+jo+bae central

Central Tee ORFS male-ORFS male adjustable-BSP male

Raccordo a T orientabile ORFS BSP centrale

ROSCA THREAD	REFERENCIA PART N°	€	
ORFS 9/16"-18h	BSP 1/8"	OR7030402	3,80
ORFS 9/16"-18h	BSP 1/4"	OR7030404	6,73
ORFS 11/16"-16h	BSP 1/4"	OR7030604	5,67
ORFS 11/16"-16h	BSP 3/8"	OR7030606	6,66
ORFS 13/16"-16h	BSP 3/8"	OR7030806	6,11
ORFS 1"-14h	BSP 1/2"	OR7031008	9,08
ORFS 1"-14h	BSP 1/4"	OR7031012	12,43
ORFS 1"3/16-12h	BSP 1/4"	OR7031212	13,31
ORFS 1"7/16-12h	BSP 1"	OR7031616	21,07
ORFS 1"11/16-12h	BSP 1" 1/4	OR7032020	29,87

TE Regulable ORFS-BSP Lateral



Té mâle ORFS-mâle gaz cyl or+jo+bae+mâleORFS lateral

Lateral Tee ORFS male-BSP male adjustable-ORFS male

Raccordo a T orientabile ORFS BSP laterale

ROSCA THREAD	REFERENCIA PART N°	€	
ORFS 9/16"-18h	BSP 1/8"	OR7040402	17,32
ORFS 9/16"-18h	BSP 1/4"	OR7040404	17,53
ORFS 11/16"-16h	BSP 1/4"	OR7040604	5,63
ORFS 11/16"-16h	BSP 3/8"	OR7040606	21,81
ORFS 1"-14h	BSP 3/4"	OR7041012	33,94
ORFS 1"11/16-12h	BSP 1" 1/4	OR7042020	66,08
ORFS 2"-12h	BSP 1" 1/2	OR7042424	75,58

TE macho-macho-hembra giratoria Central



Té mâle ORFS-mâle ORFS-femelle tournante ORFS

Tee ORFS male-ORFS male-ORFS swivel female

Raccordo a T maschio-maschio-femmina girevole centrale ORFS

ROSCA THREAD	REFERENCIA PART N°	€
ORFS 9/16"-18h	OR7010404	13,98
ORFS 11/16"-16h	OR7010606	16,68
ORFS 13/16"-16h	OR7010808	18,22
ORFS 1"-14h	OR7011010	22,96
ORFS 1"3/16-12h	OR7011212	30,24
ORFS 1"7/16-12h	OR7011616	57,15
ORFS 1"11/16-12h	OR7012020	83,21
ORFS 2"-12h	OR7012424	111,44

TE macho-macho-hembra giratoria Lateral

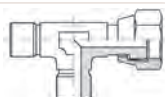

Té mâle ORFS-femelle tournante ORFS-mâle ORFS

Tee ORFS male-ORFS swivel female-ORFS male

Raccordo a T maschio-maschio-femmina girevole laterale ORFS

ROSCA THREAD	REFERENCIA PART N°	€
ORFS 9/16"-18h	OR7020404	5,49
ORFS 11/16"-16h	OR7020606	6,72
ORFS 13/16"-16h	OR7020808	9,39
ORFS 1"-14h	OR7021010	11,41
ORFS 1"3/16-12h	OR7021212	16,97
ORFS 1"7/16-12h	OR7021616	27,74
ORFS 1"11/16-12h	OR7022020	46,30

ORFS

Quick-release
couplings

Ball valves, diverters

Protections

Artículos bajo consulta

Articles à consulter | Items on request | Articoli su richiesta

OR305

Adaptador hembra giratoria ORFS-macho JIC 37° | Femelle tournante ORFS-mâle JIC 37° | ORFS Swivel female-JIC 37° male | Adattatore femmina girevole ORFS-maschio JIC 37°

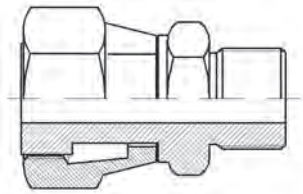

OR416

Codo 90° macho ORFS - macho BSPT | Coude 90° mâle ORFS-mâle BSPT | 90° Elbow ORFS male-BSPT male | Raccordo a 90° maschio ORFS-maschio BSPT

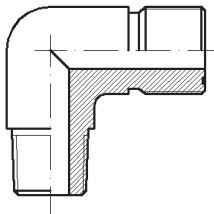

OR505

Codo 45° regulable ORFS-UNF | Coude 45° mâle ORFS-mâle UNF or+jo+bae | Adjustable 45° elbow ORFS male-UNF male | Raccordo a 45° orientabile ORFS-UNF

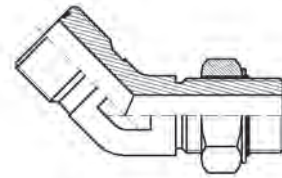

OR705

Te Regulable macho ORFS- macho UNF lateral | Té mâle ORFS-mâle ORFS-mâle UNF+or+jo+bae | Tee ORFS male-ORFS male-lateral UNF adjustable male | Raccordo a T orientabile maschio ORFS-UNF laterale

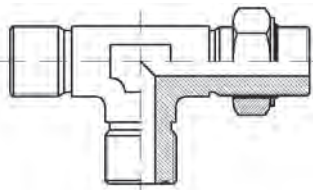

OR706

Te Regulable macho ORFS- macho UNF central | Té mâle ORFS-mâle UNF+or+jo+bae-mâle ORFS | Tee ORFS male-central UNF adjustable male-ORFS male | Raccordo a T orientabile maschio ORFS-UNF centrale

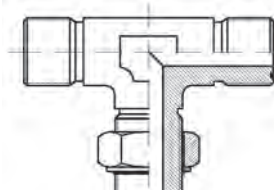

Enchufes rápidos

Coupleurs rapides
Quick-release couplings
Innesti rapidi

3

Enchufes rápidos

224

Coupleurs rapides | Quick-release couplings | Innesti rapidi

Multienchufe

225

Multi-coupleur | Multi-way coupling | Multinesti

Enchufes rápidos

Coupleurs rapides | Quick-release couplings | Innesti rapidi

Adaptors

ORFS

Quick-release couplings

Ball valves, diverters

Protections

▶ Enchufes válvula plana | Coupleurs rapides à clapet face plane | Flat face quick release couplings | Innesti a faccia piana 227



A9001/A9002

A9011/A9012

A900...M...P

A9021

A8701/A8702

▶ Enchufes punzón | Coupleurs rapides à clapet | Quick release couplings | Innesti a valvola 228



A800/A802

A807/A844

A8101/A8102

A8311/A8312

A840

A80/A84

A8201/A8202



A845/A890

A801

A8211/A8212

A8103/A8104

A803

▶ Enchufes autoroscantes | Coupleurs rapides à visser | Quick release screw couplings | Innesti a vite 230



A8008/A8009

▶ Enchufes de bola | Coupleurs rapides à bille | Quick release couplings ball type | Innesti a sfera 230



A7001/A7002

A700...TAZ

A70/A74

A706/A711

A701

A703

▶ Válvulas de frenado | Valves freinage | Brake valves | Valvole di frenaggio 231



A910/A912

A9102

A9501/A9141

A9502

▶ Accesorios para enchufes | Accessoires pour coupleurs rapides | Accessories for couplings | Accessori per innesto rapido 232



A9901/A9902

A9911/A9912

A9931/A9932

NBRA

PTFEA

▶ Multienchufe

Multi-coupleur | Multi-way coupling | Multinesti

▶ **Multienchufe 4 vías** | Multi-coupleur 4 voies | Multi-way coupling 4 ways | Multinesti 4 vie

233



MEC4



MEM4



MEH4



A930/A940

▶ **Multienchufe 2 vías** | Multi-coupleur 2 voies | Multi-way coupling 2 ways | Multinesti 2 vie

233



MEC2



MEM2



MEH2

▶ **Accesorios multienchufe** | Accessoires Multi-coupleur | Multi-way coupling accessories | Accessori per multinesti

234



CEM



--

Adaptors

ORFS

Quick-release couplings

Ball valves, diverters

Protections

Enchufes rápidos

Coupleurs rapides
Quick-release couplings
Innesti rapidi

E.R. Válvula plana Ecológico (rosca BSP)



Coupleur rapide à clapet face plane "Ecologique" filetage BSP
BSP Ecological flat face coupling
Innesto rapido a faccia piana Ecologico BSP

DN	ROSCA THREAD	E. C.	REFERENCIA PART N°	€
6	1/4" BSP	M	A900104	15,21
13	3/8" BSP	M	A900106	18,36
13	1/2" BSP	M	A900108	18,36
20	3/4" BSP	M	A900112	29,29
20	1" BSP	M	A900116	60,19
30	1" 1/4 BSP	M	A900120	106,02
39	1" 1/2 BSP	M	A900124	196,60
6	1/4" BSP	H	A900204	32,68
13	3/8" BSP	H	A900206	35,03
13	1/2" BSP	H	A900208	35,03
20	3/4" BSP	H	A900212	55,03
20	1" BSP	H	A900216	122,22
30	1" 1/4 BSP	H	A900220	167,44
39	1" 1/2 BSP	H	A900224	355,76

E.R. Válvula plana Ecológico (rosca NPT)



Coupleur rapide à clapet face plane "Ecologique" filetage NPT
NPT Ecological flat face coupling
Innesto rapido a faccia piana Ecologico NPT

DN	ROSCA THREAD	E. C.	REFERENCIA PART N°	€
6	1/4" NPT	M	A901104	15,21
13	3/8" NPT	M	A901106	18,36
13	1/2" NPT	M	A901108	18,36
20	3/4" NPT	M	A901112	29,29
25	1" NPT	M	A901116	60,19
30	1" 1/4 NPT	M	A901120	106,02
6	1/4" NPT	H	A901204	32,68
13	3/8" NPT	H	A901206	35,03
13	1/2" NPT	H	A901208	35,03
20	3/4" NPT	H	A901212	55,03
20	1" NPT	H	A901216	122,22
30	1" 1/4 NPT	H	A901220	167,44

E.R. Válvula plana pasatabique (rosca Métrica)



Coupleur rapide à clapet face plane passe cloison (filetage Métrique)
Flat face coupling bulkhead (Metric thread)
Innesto a faccia piana passaparete (Metrico)

DN	ROSCA THREAD	E. C.	REFERENCIA PART N°	€
6	M16x1.5	M	A9001M16P	20,27
13	M18x1.5	M	A9001M18P	24,28
20	M26x1.5	M	A9001M26P	41,36
13	M18x1.5	H	A9002M18P	48,02
20	M26x1.5	H	A9002M26P	71,85

E.R. Válvula plana Ecológico acoplamiento en presión

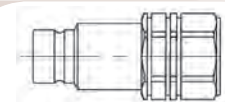

Coupleur rapide à clapet face plane "Ecologique" pression
Flat face quick release coupling connectable u/pressure
Innesto rapido a faccia piana Ecologico innestabile in pressione

DN	ROSCA THREAD	E. C.	REFERENCIA PART N°	€
13	1/2" BSP	M	A902108	71,54
20	3/4" BSP	M	A902112	79,08

Se montan con enchufe hembra A870... // À monter avec coupleur femelle A870... //
To assemble with female coupling A870... // Per montare con innesto femmina A870...

E.R. Válvula plana para martillos



Coupleur rapide à clapet face plane (marteau)
Flat face quick releale coupling inner threads
Innesto rapido a faccia piana per martelli

DN	ROSCA THREAD	E. C.	REFERENCIA PART N°	€
6	1/4" BSP	M	A870104	15,43
13	3/8" BSP	M	A870106	20,58
13	1/2" BSP	M	A870108	20,58
20	3/4" BSP	M	A870112	31,17
25	1" BSP	M	A870116	48,63
30	1" 1/4 BSP	M	A870120	108,33
6	1/4" BSP	H	A870204	33,85
13	3/8" BSP	H	A870206	43,83
13	1/2" BSP	H	A870208	43,83
20	3/4" BSP	H	A870212	61,16
25	1" BSP	H	A870216	111,63
30	1" 1/4 BSP	H	A870220	189,61

Enchufes rápidos

Coupleurs rapides
Quick-release couplings
Innesti rapidi

Adaptors

ORFS

Quick-release couplings

Ball valves, diverters

Protections

E.R. Punzón ISO A (rosca BSP)

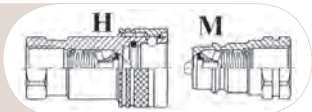

Coupleur rapide à clapet norme ISO A
ISO A Quick release coupling
Innesto rapido a valvola ISO A (BSP)

DN	ROSCA THREAD	E. C.	REFERENCIA PART N°	€
6	1/4" BSP	M	A800104	5,20
10	3/8" BSP	M	A800106	5,61
13	1/2" BSP	M	A800108	5,71
20	3/4" BSP	M	A800112	12,66
25	1" BSP	M	A800116	28,56
30	1" 1/4 BSP	M	A800120	65,64
39	1" 1/2 BSP	M	A800124	82,05
50	2" BSP	M	A800132	153,20
6	1/4" BSP	H	A800204	10,65
10	3/8" BSP	H	A800206	12,35
13	1/2" BSP	H	A800208	14,02
20	3/4" BSP	H	A800212	24,88
25	1" BSP	H	A800216	52,13
30	1" 1/4 BSP	H	A800220	131,33
39	1" 1/2 BSP	H	A800224	184,35
50	2" BSP	H	A800232	310,83
13	M22X1.5	M	A802122	5,71
13	M22X1.5	H	A802222	14,02

E.R. ISO Paso total

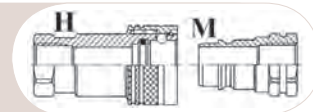

Coupleur rapide à clapet ISO A pass.total
ISO A Quick release coupling free flow
Innesto rapido ISO A passaggio libero

DN	ROSCA THREAD	E. C.	REFERENCIA PART N°	€
6	1/4" BSP	M	A831104	3,65
10	3/8" BSP	M	A831106	4,32
13	1/2" BSP	M	A831108	4,34
20	3/4" BSP	M	A831112	10,03
25	1" BSP	M	A831116	26,24
6	1/4" BSP	H	A831204	9,83
10	3/8" BSP	H	A831206	10,65
13	1/2" BSP	H	A831208	12,92
20	3/4" BSP	H	A831212	22,48
25	1" BSP	H	A831216	49,81

E.R. Punzón ISO A -acoplamiento a presión residual

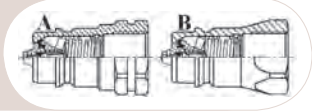

Coupleur rapide à clapet accouplable sous pression résiduelle
ISO A Quick release coupling (coupling under residual pressure)
Innesto rapido a valvole ISO a innestabili in pressione residua

DN	ROSCA THREAD	ENCHUFE COUPLING	REFERENCIA PART N°	€
13	1/2" BSP	M (Tipo B)	A807108	12,96
13	1/2" BSP	M (Tipo A)	A844108	12,96

E.R. Punzón ISO B (rosca BSP)

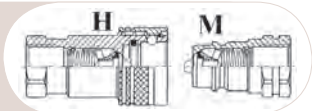

Coupleur rapide à clapet norme ISO B
ISO B Quick release coupling
Innesto rapido a valvola ISO B

DN	ROSCA THREAD	E. C.	REFERENCIA PART N°	€
6	1/4" BSP	M	A810104	5,56
10	3/8" BSP	M	A810106	5,70
13	1/2" BSP	M	A810108	6,70
20	3/4" BSP	M	A810112	14,24
25	1" BSP	M	A810116	31,74
6	1/4" BSP	H	A810204	12,86
10	3/8" BSP	H	A810206	16,05
13	1/2" BSP	H	A810208	21,51
20	3/4" BSP	H	A810212	41,44
25	1" BSP	H	A810216	69,40

E.R. Push-Pull Punzón hembra

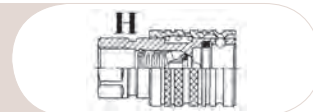

Coupleur rapide à clapet type push-pull femelle norme ISO A
Female Push-Pull Quick release coupling
Innesto rapido Push-Pull femmina valvola ISO A

DN	ROSCA THREAD	E. C.	REFERENCIA PART N°	€
13	1/2" BSP	H	A840208	15,86
13	1/2" NPT	H	A841208	15,86
13	M22X1.5	H	A842222	15,86
13	3/4" UNF	H	A843234	15,86

E.R. Push-Pull Punzón macho



Coupleur rapide à clapet type push-pull mâle norme ISO A
Male Push-Pull Quick release coupling
Innesto rapido Push-Pull maschio valvola ISO A

DN	ROSCA THREAD	ENCHUFE COUPLING	REFERENCIA PART N°	€
13	1/2" NPT	M (Tipo A)	A804108	5,71
13	1/2" NPT	M (Tipo A)	A841108	5,71
13	M22X1.5	M (Tipo A)	A842122	5,71
13	1/2" BSP	M (Tipo B)	A840108	5,71
13	3/4" UNF	M (Tipo B)	A843134	5,71
13	1/2" BSP	M (Tipo C)	A805108	12,96
13	1/2" NPT	M (Tipo C)	A806108	12,96

Enchufes rápidos

Coupleurs rapides
Quick-release couplings
Innesti rapidi

E.R. Punzón Serie NV1 (rosca BSP)

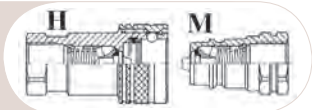

Coupleur rapide à clapet serie NV 1
Quick release coupling NV1 serie
Innesto rapido valvola Serie NV1

DN	ROSCA THREAD	E. C.	REFERENCIA PART N°	€
6	1/4" BSP	M	A820104	5,43
10	3/8" BSP	M	A820106	5,83
20	3/4" BSP	M	A820112	14,02
20	1" BSP	M	A820116	31,11
30	1" 1/4 BSP	M	A820120	65,64
39	1" 1/2 BSP	M	A820124	83,24
50	2" BSP	M	A820132	231,48
6	1/4" BSP	H	A820204	11,52
10	3/8" BSP	H	A820206	13,54
20	3/4" BSP	H	A820212	31,54
25	1" BSP	H	A820216	55,68
30	1" 1/4 BSP	H	A820220	131,33
39	1" 1/2 BSP	H	A820224	170,16
50	2" BSP	H	A820232	382,90

E.R. Punzón Serie NV1 (rosca NPT)

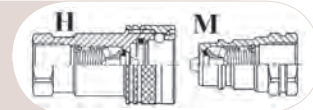

Coupleur rapide à clapet serie NV 1 NPT
NPT Quick release couplings NV1 serie
Innesto rapido a valvola serie NV 1 NPT

DN	ROSCA THREAD	E. C.	REFERENCIA PART N°	€
6	1/4" NPT	M	A821104	5,43
10	3/8" NPT	M	A821106	5,83
13	1/2" NPT	M	A821108	5,71
20	3/4" NPT	M	A821112	14,02
25	1" NPT	M	A821116	31,11
30	1" 1/4 NPT	M	A821120	65,64
39	1" 1/2 NPT	M	A821124	83,24
50	2" NPT	M	A821132	231,48
6	1/4" NPT	H	A821204	11,52
10	3/8" NPT	H	A821206	13,54
13	1/2" NPT	H	A821208	14,02
20	3/4" NPT	H	A821212	31,54
25	1" NPT	H	A821216	55,68
30	1" 1/4 NPT	H	A821220	131,33
39	1" 1/2 NPT	H	A821224	170,16
50	2" NPT	H	A821232	382,90

E.R. John Deere



Coupleur rapide à clapet special John Deere
John Deere Quick release coupling
Innesto rapido Jhon Deere

DN	ROSCA THREAD	E. C.	REFERENCIA PART N°	€
13	3/4" SAE	M	A845112	12,70
13	3/4" SAE	H	A845212	25,68
13	M18X1.5-12L	M	A89011812	8,59
13	M18X1.5-12L	H	A89021812	18,09

E.R. Punzón ISO A (rosca NPT)

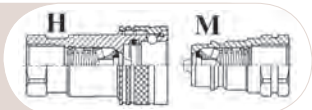

Coupleur rapide à clapet norme ISO A filetage NPT
ISO A NPT Quick release coupling
Innesto rapido a valvola ISO A NPT

DN	ROSCA THREAD	E. C.	REFERENCIA PART N°	€
6	1/4" NPT	M	A801104	5,20
10	3/8" NPT	M	A801106	5,61
13	1/2" NPT	M	A801108	5,71
20	3/4" NPT	M	A801112	12,66
25	1" NPT	M	A801116	28,56
30	1" 1/4 NPT	M	A801120	65,64
39	1" 1/2 NPT	M	A801124	82,05
50	2" NPT	M	A801132	153,20
6	1/4" NPT	H	A801204	10,65
10	3/8" NPT	H	A801206	12,35
13	1/2" NPT	H	A801208	14,02
20	3/4" NPT	H	A801212	24,88
25	1" NPT	H	A801216	52,13
30	1" 1/4 NPT	H	A801220	131,33
39	1" 1/2 NPT	H	A801224	184,35
50	2" NPT	H	A801232	310,83

E.R. Punzón ISO B (rosca NPT)



Coupleur rapide à clapet norme ISO B NPT
ISO B NPT Quick release couplings
Innesto rapido a valvola ISO B NPT

DN	ROSCA THREAD	E. C.	REFERENCIA PART N°	€
6	1/4" NPT	M	A810304	5,56
10	3/8" NPT	M	A810306	5,70
13	1/2" NPT	M	A810308	6,70
20	3/4" NPT	M	A810312	14,24
25	1" NPT	M	A810316	31,74
6	1/4" NPT	H	A810404	12,86
10	3/8" NPT	H	A810406	16,05
13	1/2" NPT	H	A810408	21,51
20	3/4" NPT	H	A810412	41,44
25	1" NPT	H	A810416	69,40

E.R. Punzón ISO A (rosca UNF)

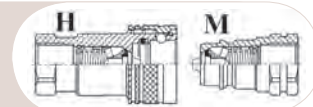

Coupleur rapide à clapet norme ISO A filetage UNF
ISO A UNF Quick release coupling
Innesto rapido a valvola ISO B UNF

DN	ROSCA THREAD	E. C.	REFERENCIA PART N°	€
13	3/4" UNF	M	A803112	5,71
13	3/4" UNF	H	A803212	14,02

Enchufes rápidos

Coupleurs rapides
Quick-release couplings
Innesti rapidi

E.R. Autoroscantes (rosca BSP)

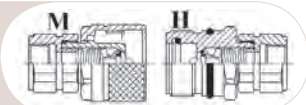

Coupleur rapide à visser taraudage norme din forme y filetage BSP
BSP Quick release screw coupling
Innesto rapido a vite (BSP)

DN	ROSCA THREAD	E. C.	REFERENCIA PART N°	€
10	1/4" BSP	M	A800804	16,98
10	3/8" BSP	M	A800806	16,98
13	1/2" BSP	M	A800808	15,53
20	3/4" BSP	M	A800812	40,23
25	1" BSP	M	A800816	47,72
10	1/4" BSP	H	A800904	16,98
10	3/8" BSP	H	A800906	16,98
13	1/2" BSP	H	A800908	15,53
20	3/4" BSP	H	A800912	40,23
25	1" BSP	H	A800916	52,57

E.R. Bola Serie NV (rosca BSP)



Coupleur rapide à bille standard
BSP Quick release coupling ball type NV Serie
Innesto rapido a sfera BSP Serie NV

DN	ROSCA THREAD	E. C.	REFERENCIA PART N°	€
6	1/4" BSP	M	A700104	5,14
10	3/8" BSP	M	A700106	6,40
13	1/2" BSP	M	A700108	7,19
20	3/4" BSP	M	A700112	14,59
25	1" BSP	M	A700116	33,12
6	1/4" BSP	H	A700204	10,39
10	3/8" BSP	H	A700206	13,01
13	1/2" BSP	H	A700208	15,55
20	3/4" BSP	H	A700212	31,24
25	1" BSP	H	A700216	58,13

E.R. Push-Pull bola

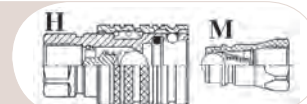

Coupleur rapide à bille Type Push-Pull
Quick release coupling ball type Push-Pull
Innesto rapido Push-Pull a sfera

DN	ROSCA THREAD	E. C.	REFERENCIA PART N°	€
13	1/2" BSP	M	A704108	8,32
13	1/2" NPT	M	A705108	8,32
13	1/2" BSP	H	A740208	16,95
13	1/2" NPT	H	A741208	16,95
13	3/4" UNF	H	A702212	16,95

E.R. Bola Tipo Taz (gondolas y semirem.)



Coupleur rapide à bille Type Taz special carrocieres
Quick release coupling ball type Type Taz (gondolas and semi-tows)
Innesto rapido a sfera tipo Taz per semirimorchio

DN	ROSCA THREAD	E. C.	REFERENCIA PART N°	€
19	3/4" BSP	M	A700112TAZ	20,40
25	1" BSP	M	A700116TAZ	28,68
19	3/4" BSP	H	A700212TAZ	37,87
25	1" BSP	H	A700216TAZ	60,69

E.R. Bola altísima presión 700 bar

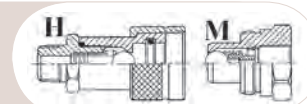

Coupleur rapide à verrouillage vissé haute pression-700 bar
Quick release coupling ball type very high pressure (700 bar)
Innesto rapido a sfera 700 bar

DN	ROSCA THREAD	E. C.	REFERENCIA PART N°	€
10	3/8" BSP	M	A706106	9,88
10	3/8" BSP	H	A706206	26,80
6	1/4" NPT	M	A711104	9,20
10	3/8" NPT	M	A711106	9,00
6	1/4" NPT	H	A711204	13,84
10	3/8" NPT	H	A711206	15,07

Enchufes rápidos

Coupleurs rapides
Quick-release couplings
Innesti rapidi

E.R. Bola Serie NV (rosca NPT)



Coupleur rapide à bille filetage NPT
NPT Quick release coupling ball type NV Serie
Innesto rapido a sfera NPT

DN	ROSCA THREAD	E. C.	REFERENCIA PART N°	€
6	1/4" NPT	M	A701104	5,14
10	3/8" NPT	M	A701106	6,40
13	3/8" NPT	M	A701108	7,19
20	3/4" NPT	M	A701112	14,59
25	1" NPT	M	A701116	33,12
6	1/4" NPT	H	A701204	10,39
10	3/8" NPT	H	A701206	13,01
13	1/2" NPT	H	A701208	15,55
20	3/4" NPT	H	A701212	31,24
25	1" NPT	H	A701216	58,13

E.R. Bola Serie NV (rosca UNF)

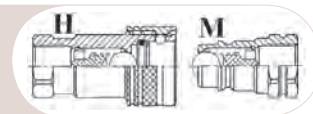

Coupleur rapide à bille filetage UNF
UNF Quick release coupling ball type NV Serie
Innesto rapido a sfera UNF

DN	ROSCA THREAD	E. C.	REFERENCIA PART N°	€
13	3/4" UNF	M	A703112	6,84
13	3/4" UNF	H	A703212	14,87

Válvula de frenado macho



Valve freinage mâle
Male brake valve
Valvola di frenaggio maschio

DN	ROSCA THREAD	ENCHUFE COUPLING	REFERENCIA PART N°	€
13	1/2" BSP	M (Tipo C)	A910508	12,71
13	M18X1.5	M (Tipo B)	A912118	12,71
13	M20X1.5	M (Tipo B)	A912120	12,71
13	M22X1.5	M (Tipo B)	A912122	13,27
13	M16X1.5-M20X1.5	M (Tipo C)	A912316	16,77
13	M18X1.5-M20X1.5	M (Tipo C)	A912318	16,77

Válvula agrícola macho



Valve agricole à visser mâle
Male agricultural valve
Valvola agricola maschio

DN	ROSCA THREAD	ENCHUFE COUPLING	REFERENCIA PART N°	€
13	1/2" BSP	M (Tipo A)	A950108	15,06
13	M18X1.5	M (Tipo B)	A950118	15,06
13	M20X1.5	M (Tipo B)	A950120	15,33
13	M22X1.5	M (Tipo B)	A950122	15,86
13	M16X1,5-M20X1,5	M (Tipo C)	A9141620	15,86
13	M18X1,5 - M20X1,5	M (Tipo C)	A9141820	17,52

Válvula agrícola hembra

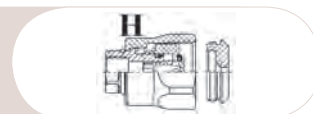

Valve agricole à visser femelle
Female agricultural valve
Valvola agricola femmina

DN	ROSCA THREAD	E. C.	REFERENCIA PART N°	€
13	3/8" BSP	H	A950206	20,68
13	M18X1.5	H	A950218	20,68

Válvula de frenado hembra

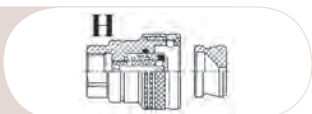

Valve freinage femelle
Female brake valve
Valvola di frenaggio femmina

DN	ROSCA THREAD	E. C.	REFERENCIA PART N°	€
13	3/8" BSP	H	A910206	23,22
13	1/2" BSP	H	A910208	23,22
13	M18X1.5	H	A910218	23,22

Enchufes rápidos

Coupleurs rapides
Quick-release couplings
Innesti rapidi

Adaptors

ORFS

Quick-release couplings

Ball valves, diverters

Protections

Tapones para enchufes rápidos ISO A



Bouchons et capuchons de plastique pour coupleurs norme ISO A
Plugs for ISO A quick release couplings

Tappi per ISO A

ROSCA THREAD	ENCHUFE COUPLING	REFERENCIA PART N°	€
1/4"	H	A990104	1,44
3/8"	H	A990106	1,44
1/2"	H	A990108	1,13
3/4"	H	A990112	2,98
1"	H	A990116	3,80
1/4"	M	A990204	1,44
3/8"	M	A990206	1,44
1/2"	M	A990208	1,13
3/4"	M	A990212	2,98
1"	M	A990216	3,80

Tapones para enchufes de válvula plana



Bouchons et capuchons de plastique pour coupleurs face plane
Plugs for flat face quick release couplings

Tappi per innesti a faccia piana

DN	ROSCA THREAD	ENCHUFE COUPLING	REFERENCIA PART N°	€
6	1/4"	H	A993104	5,62
10	3/8"	H	A993106	2,69
13	1/2"	H	A993108	4,21
20	3/4"	H	A993112	3,42
6	1/4"	M	A993204	5,62
10	3/8"	M	A993206	4,24
13	1/2"	M	A993208	4,21
20	3/4"	M	A993212	3,42

Juego de juntas de reparación e.r. ISO A



Jeu de joints pour coupleur ISO A

Kit of seals to repair for ISO A quick release coupling

Guarnizioni per innesto ISO A

ROSCA THREAD	REFERENCIA PART N°	€
1/4" BSP	NBRA04	0,47
3/8" BSP	NBRA06	0,52
1/2" BSP	NBRA08	0,64
3/4" BSP	NBRA12	0,70
1" BSP	NBRA16	0,76

Tapones para enchufes ISO B



Bouchons et capuchons de plastique pour coupleurs ISO B
Caps and plugs for ISO B quick release coupling

Tappi per ISO B

DN	ROSCA THREAD	ENCHUFE COUPLING	REFERENCIA PART N°	€
DN 6	1/4"	H	A991104	4,16
DN 10	3/8"	H	A991106	4,16
DN 10	1/2"	H	A991108	4,16
DN 6	1/4"	M	A991204	4,16
DN 13	3/8"	M	A991206	4,16
DN 13	1/2"	M	A991208	4,16

Arandelas Teflón



Rondelles Teflon

PTFE seals

Rondelle a teflon

ROSCA THREAD	REFERENCIA PART N°	€
1/4" BSP	PTFEA04	0,64
3/8" BSP	PTFEA06	0,81
1/2" BSP	PTFEA08	0,87
3/4" BSP	PTFEA12	1,45
1" BSP	PTFEA16	1,45

Multienchufe

Multi-coupleur
Multi-way coupling
Multinesti

Enchufes rápidos ME4V



Multi-coupleur 4 voies complète
Complet Multi-way coupling 4 ways
Multinesti 4 vie complete

Descripción Description	ENCHUFE COUPLING	Nº VIAS Nº WAYS	REFERENCIA PART N°	€
-	2 x H 1/2" BSP	4	MEC42H08	335,77
-	2 x M 1/2" BSP	4	MEC42M08	346,40
-	4 x H 1/2" BSP	4	MEC44H08	488,06
-	4 x M 1/2" BSP	4	MEC44M08	509,32
Electrico	4 x M 1/2" BSP	4	MEC44M08E	545,39
-	-	4	MEC4S	177,82

Conjunto hembra ME4V



Multi-coupleur 4 voies partie femelle
Female part of multi-way coupling 4 ways
Multinesti 4 vie parte femmina

ENCHUFE COUPLING	Nº VIAS Nº WAYS	REFERENCIA PART N°	€
2 x H 1/2" BSP	4	MEH42H08	155,37
2 x M 1/2" BSP	4	MEH42M08	155,37
4 x H 1/2" BSP	4	MEH44H08	231,52
4 x M 1/2" BSP	4	MEH44M08	231,52
-	4	MEH4S	75,06

Conjunto macho ME4V



Multi-coupleur 4 voies partie mâle
Male part of multi-way coupling 4 ways
Multinesti 4 vie parte maschio

ENCHUFE COUPLING	Nº VIAS Nº WAYS	REFERENCIA PART N°	€
2 x H 1/2" BSP	4	MEM42H08	180,39
2 x M 1/2" BSP	4	MEM42M08	180,39
4 x H 1/2" BSP	4	MEM44H08	256,54
4 x M 1/2" BSP	4	MEM44M08	256,54
-	4	MEM4S	100,08

Enchufes rápidos ME4V



Coupleurs rapides Multi-coupleur 4 voies
Multi-way coupling 4 ways quick-release couplings
Innesti rapidii per multinesti

ROSCA THREAD	ENCHUFE COUPLING	REFERENCIA PART N°	€
H 1/2" BSP	M	A930108	34,62
H 1/2" BSP	H	A930208	34,62
M 1/2" BSP	M	A940108	37,05
M 1/2" BSP	H	A940208	37,03

ME2V completo



Multi-coupleur 2 voies complète
Complete multi-way coupling 2 ways
Multinesti 2 vie complete

D. D.	ENCHUFE COUPLING	Nº VIAS Nº WAYS	REFERENCIA PART N°	€
-	2 x H 1/2" BSP	2	MEC22H08	299,07
-	2 x M 1/2" BSP	2	MEC22M08	309,71

Conjunto hembra ME2V



Multi-coupleur 2 voies partie femelle
Female part of multi-way coupling 2 ways
Multinesti 2 vie parte femmina

ENCHUFE COUPLING	Nº VIAS Nº WAYS	REFERENCIA PART N°	€
2 x H 1/2" BSP	2	MEH22H08	137,03
2 x M 1/2" BSP	2	MEH22M08	162,05
-	2	MEH2S	66,72

Conjunto macho ME2V



Multi-coupleur 2 voies partie mâle
Male part of multi-way coupling 2 ways
Multinesti 2 vie parte maschio

ENCHUFE COUPLING	Nº VIAS Nº WAYS	REFERENCIA PART N°	€
2 x H 1/2" BSP	2	MEM22H08	137,03
2 x M 1/2" BSP	2	MEM22M08	162,05
-	2	MEM2S	79,23

Multienchufe

Multi-coupleur
Multi-way coupling
Multinesti

Adaptors

ORFS

Quick-release couplings

Ball valves, diverters

Protections

Componentes eléctricos



Composants électriques
Electrical components
Componenti elettrici

Descripción Description	REFERENCIA PART N°	€
Conector H // 3 Pin	CEM-H	16,11
Conector M // 3 Pin	CEM-M	16,64
Conector H // 7 Pin	CEM7-H	22,24
Conector M // 7 Pin	CEM7-M	25,05

Repuestos

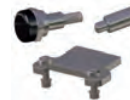

Pièces de rechange
Spare parts
Pezzi di ricambio

Descripción Description	REFERENCIA PART N°	€
Conj. Tapa	MEC4TP	64,43
Conj. Tapa Electr.	MEC4TPEL	77,31
Chapa Sujeción	MEC4CS	8,16
Conjunto accionamiento	MEC4ACC	36,49
Conjunto cierre	MEC4SG	12,75

▶ MEC4TP

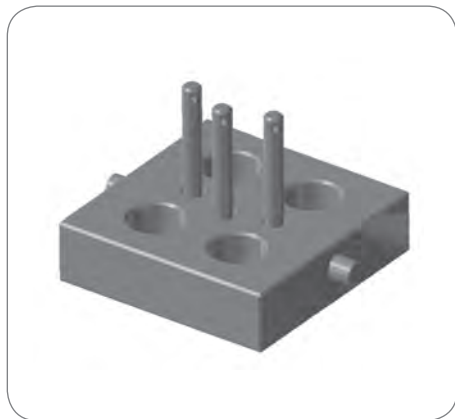

▶ MEC4ACC



▶ MEC4TPEL

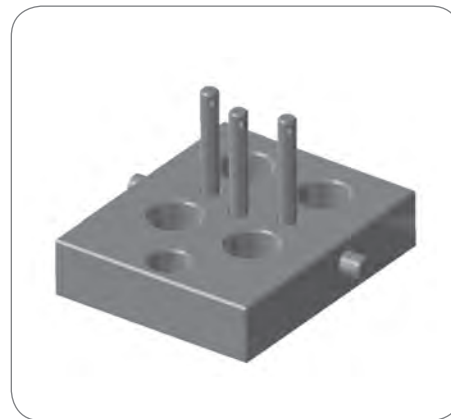

▶ MEC4SG



▶ MEC4GIR



▶ MEC4CS



Multienchufe

Multi-coupleurs | Multiway couplings | Multinnesti 4 vie

Características | Caractéristiques | Characteristics | Caratteristiche

- “Fugas Cero” enchufes ecológicos de caras planas
 - Se pueden acoplar y desacoplar en presión
 - Cómoda apertura y cierre
 - Fácil mantenimiento y limpieza
 - Como opción se puede suministrar con acoplamiento eléctrico integrado
- Pas de fuites: coupleurs écologiques face plane
 - Ils peuvent s'accoupler / des'accoupler en pression
 - Ouverture / fermeture facile
 - Entretien / maintenance facile
 - En option peut être fourni avec accouplement électrique intégré
- “No leaks” flat face “Ecological” quick couplings
 - They can be coupled and uncoupled within pressure
 - Handy opening and closing
 - Easy to maintain and to clean
 - Option: they could be supplied with an electric coupling integrated
- “Zero perdita”, innesto rapido ecologico faccia piana
 - Innestabile e disinnestabile in pressione
 - Comoda apertura e chiusura
 - Facile manutenzione e pulizia
 - Opzione: Possibile fornitura con accoppiamento elettrico integrato



Disponibles con roscas hembra BSP-1/2 o macho BSP-1/2. Se suministran con 2 ó 4 enchufes | Disponibles avec filetages femelle BSP-1/2 ou mâle BSP-1/2. Ils sont livrés avec 2 ou 4 coupleurs | Available with thread female BSP 1/2 or male BSP 1/2. They are supplied with 2 or 4 couplings | Disponibili con filetti femina BSP 1/2 o maschio BSP 1/2, sono fornibili con 2 o 4 innesti.

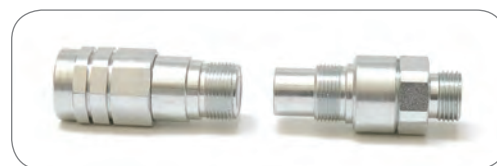

Accesorios | Accessoires | Accessories | Accessori

Tapa de protección | Couvercle de protection | Protection cap | Tappo di protezione



Chapa de sujeción | Plaque de fixation | Subjection plate | Piastra di sicurezza

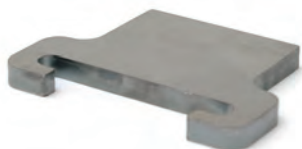

Enchufes repuesto | Coupleurs de réchange | Spare couplings | Innesti di ricambio



Referencia Référence Part No. Codice	Descripción Description Description Descrizione	Uds caja Pcs. boîte Pcs./box Uds. box	€
MEC44H08	Multienchufe 4 rosca hembra BSP Multicoupleur 4 filetage femelle BSP Multi quick coupling 4 thread female BSP Multinnesto 4 filetto femina BSP	1	475,71
MEC42H08	Multienchufe 2 rosca hembra BSP Multicoupleur 2 filetage femelle BSP Multi quick coupling 2 thread female BSP Multinnesto 2 filetto femina BSP	1	325,71
MEC44M08	Multienchufe 4 rosca macho BSP Multicoupleur 4 filetage mâle BSP Multi quick coupling 4 thread male BSP Multinnesto 4 filetto maschio BSP	1	492,86
MEC42M08	Multienchufe 2 rosca macho BSP Multicoupleur 2 filetage mâle BSP Multi quick coupling 2 thread male BSP Multinnesto 2 filetto maschio BSP	1	342,86

Accesorios | Accessoires | Accessories | Accessori

Referencia Référence Part No. Codice	Descripción Description Description Descrizione	Uds caja Pcs. boîte Pcs./box Uds. box	€
MEC4TP	Tapa de protección multienchufes 4 vías Couvercle de protection multi-coupleurs 4 voies 4 ways multi quick coupling protection cap Tappo di protezione per multinnesti 4 vie	12	64,29
MEC4CS	Chapa de sujeción multienchufes Tape de fixation multi-coupleurs Multi quick couplings subjection plate Piastra di sicurezza per multinnesti 4 vie	15	8,14

Repuestos | Pieces de réchange | Spare parts | Ricambi

Referencia Référence Part No. Codice	Descripción Description Description Descrizione	Uds caja Pcs. boîte Pcs./box Uds. box	€
A930108	Enchufe macho - rosca hembra 1/2 Coupleur mâle - filetage femelle 1/2 Male quick coupling - female thread 1/2 Innesto maschio - filetto femina 1/2	10	34,91
A930208	Enchufe hembra - rosca hembra 1/2 Coupleur femelle - filetage femelle 1/2 Female quick coupling - female thread 1/2 Innesto femina - filetto femina 1/2	10	34,91
A940108	Enchufe macho - rosca macho 1/2 Coupleur mâle - filetage mâle 1/2 Male quick coupling - male thread 1/2 Innesto maschio - filetto maschio 1/2	10	37,33
A940208	Enchufe hembra - rosca macho 1/2 Coupleur mâle - filetage femelle 1/2 Male quick coupling - female thread 1/2 Innesto femina - filetto maschio 1/2	10	37,33

Llaves paso, desviadores y racores giratorios

Robinets, déviateurs et raccords tournants

Ball valves, diverters and swivel fittings

Rubinetti, deviatori, raccordi girevoli

4

Llaves de paso Robinets Ball valves Rubinetti a sfera	238
Desviadores Déviateurs Diverters Deviatori di flusso	239
Racores giratorios Raccords tournants Swivel fittings Raccordi girevoli	240

Llaves de paso

Robinets | Ball valves | Rubinetti a sfera

Adaptors

▶ De 2 vías | Robinets haute pression 2 voies | 2 Ways ball valve | Rubinetti a sfera 2 vie

241



BKH G



BKH G DN



BKH L



BKH L DN



BKH G NPT



BKH S



BKH S DN

ORFS

▶ De 3 vías | Robinets haute pression 3 voies | 3 Ways ball valve | Rubinetti a sfera 3 vie

242



BK3 G



A6003



3KH G

Quick-release couplings

▶ De 4 vías | Robinets haute pression 4 voies | 4 Ways ball valve | Rubinetti a sfera 4 vie

242



4KH G

Ball valves, diverters

▶ Llaves de baja presión | Robinets basse pression | Ball valves low pressure | Rubinetti a sfera bassa pressione

244



BP2V

Protections

▶ Llaves especiales y complementos | Robinets speciaux et compléments | Special ball valves and Accessories | Rubinetti speciali e accessori

244



A600

Desviadores

Déviateurs | Diverters | Deviatori di flusso

245

Desviadores manuales | Déviateurs manuels | Manual diverters | Deviatori di flusso manuali



D3V



D4V



D6V

Racores giratorios

Raccords tournants | Swivel fittings | Raccordi girevoli

Adaptors

► **Racores giratorios (50 rev/min)** | Raccords tournants (max. 50 tr/min) | Swivel fittings | Raccordi girevoli

246



GGL



GG90

ORFS

Quick-release
couplings

Ball valves, diverters

Protections

▶ Llaves de paso

Robinets
Ball valves
Rubinetti a sfera

Llave 2 vías rosca hembra BSP con agujeros



Robinet haute pression 2 voies boisseau spherique BSP avec trous de fixation
2 Ways ball valve BSP female with holes
Rubinetto a sfera femmina-femmina BSP

DN	ROSCA THREAD	REFERENCIA PART N°	€
4	1/8" BSP	BKH G 1/8	28,46
6	1/4" BSP	BKH G 1/4	21,89
10	3/8" BSP	BKH G 3/8	20,27
13	1/2" BSP	BKH G 1/2	23,00
20	3/4" BSP	BKH G 3/4	48,25
25	1" BSP	BKH G 1	66,73
25/32	1" 1/4 BSP	BKH G 1 1/4 DN25	86,96
25	1" 1/2 BSP	BKH G 1 1/2 DN25	108,98

Llave de paso BSP hembra ISO 228



Robinets haute pression 2 voies boisseau spherique femelle ISO 228
Ball-valves BSP female ISO 228
Rubinetto a sfera femmina BSP ISO228

DN	ROSCA THREAD	REFERENCIA PART N°	€
32	1" 1/4 BSP	BKH G 1 1/4 DN32	232,72
40	1" 1/2 BSP	BKH G 1 1/2 DN40	268,88
50	2" BSP	BKH G 2 DN50	398,93

Llave 2 vías tubo rígido Serie Ligera



Robinet haute pression 2 voies boisseau spherique sortieur pour tube rigide DIN Série Légère
2 Ways ball valve: tube connection Serie Light
Rubinetto a sfera maschio DIN 2353 Serie L

DN	TUBO PIPE	ROSCA THREAD	REFERENCIA PART N°	€
4	6L	M12x1.5	BKH 6 L	27,76
6	8L	M14x1.5	BKH 8 L	23,25
8	10L	M16x1.5	BKH 10 L	23,78
10	12L	M18x1.5	BKH 12 L	27,19
13	15L	M22x1.5	BKH 15 L	28,72
16	18L	M26x1.5	BKH 18 L	65,77
20	22L	M30x2	BKH 22 L	68,31
25	28L	M36x2	BKH 28 L	90,37

Llave 2 vías tubo rígido L paso total



Robinets haute pression 2 voies boisseau spherique femelle ISO 228
Ball-valves: tube conecction L serie DIN 2353 full bore
Rubinetto a sfera maschio DIN 2353 -L-

DN	TUBO PIPE	ROSCA THREAD	REFERENCIA PART N°	€
32	35L	M45x2	BKH 35 L DN32	265,69
40	40L	M52x2	BKH 42 L DN40	352,38

Llave 2 vías rosca hembra NPT



Robinet haute pression 2 voies boisseau spherique sortieur femelle briggs (NPT)
2 Ways ball valve NPT female
Rubinetto a sfera 2 vie femmina NPT

DN	ROSCA THREAD	REFERENCIA PART N°	€
6	1/4" NPT	BKH G 1/4 NPT	41,11
10	3/8" NPT	BKH G 3/8 NPT	47,64
13	1/2" NPT	BKH G 1/2 NPT	55,74
20	3/4" NPT	BKH G 3/4 NPT	90,68
25	1" NPT	BKH G 1 NPT	117,17
32	1" 1/4 NPT	BKH G 1 1/4 NPT	156,40
40	1" 1/2 NPT	BKH G 1 1/2 NPT	165,99
50	2" NPT	BKH G 2 NPT	384,65

Llave 2 vías tubo rígido Serie Pesada



Robinet haute pression 2 voies boisseau spherique sortieur pour tube rigide din Série Lourde
2 Ways ball valve: tube connection Serie Heavy
Rubinetto a sfera maschio DIN Serie S

DN	TUBO PIPE	ROSCA THREAD	REFERENCIA PART N°	€
4	8S	M16x1.5	BKH 8 S	30,83
6	10S	M18x1.5	BKH 10 S	25,79
8	12S	M20x1.5	BKH 12 S	23,56
10	14S	M22x1.5	BKH 14 S	43,17
13	16S	M24x1.5	BKH 16 S	29,29
16	20S	M30x2	BKH 20 S	65,77
20	25S	M36x2	BKH 25 S	65,46
25	30S	M42x2	BKH 30 S	88,14

Llave 2 vías tubo rígido S paso total



Robinets haute pression 2 voies boisseau spherique metrique Série Lourde passage total
Ball-valves: tube conecction S serie DIN 2353 full bore
Rubinetto a sfera maschio DIN 2353 -S-

DN	TUBO PIPE	ROSCA THREAD	REFERENCIA PART N°	€
32	38S	M52x2	BKH 38 S DN32	270,20

Llaves de paso

Robinets
Ball valves
Rubinetti a sfera

Adaptors

ORFS

Quick-release couplings

Ball valves, diverters

Protections

Llave 3 vías hembra-hembra-hembra BSP (Tipo L)



Robinet haute pression 3 voies série "L" boisseau spherique femelle-femelle-femelle BSP
3 Ways ball valve BSP female-female-female (Type L)
Rubinetto a sfera 3 vie femmina (Tipo L)

DN	ROSCA THREAD	REFERENCIA PART N°	€
6	1/4" BSP	BK3 G 1/4	70,80
10	3/8" BSP	BK3 G 3/8	67,34
13	1/2" BSP	BK3 G 1/2	71,24
20	3/4" BSP	BK3 G 3/4	164,06

Llave 3 vías hembra multivía (Tipo L)



Robinet haute pression 3 voies série "L" boisseu spherique femelle gaz
Multi-way ball valves female 3 ways (Type L)
Rubinetto a sfera 3 vie femmina (Tipo L)

DN	ROSCA THREAD	REFERENCIA PART N°	€
4	1/8" BSP	3KH G 1/8	243,01
6	1/4" BSP	3KH G 1/4	195,46
10	3/8" BSP	3KH G 3/8	237,97
13	1/2" BSP	3KH G 1/2	334,65
20	3/4" BSP	3KH G 3/4	500,29
25/32	1" 1/4 BSP	3KH G 1 1/4	634,09
25/40	1" 1/2 BSP	3KH G 1 1/2	644,34

Llave 3 vías hembra-macho-hembra BSP (Tipo L)



Robinet haute pression 3 voies série "L" boisseu spherique femelle-mâle-femelle BSP
3 Ways ball valve BSP female-male-female (Type L)
Rubinetto a sfera 3 vie femmina-maschio-femmina BSP (Tipo L)

DN	ROSCA THREAD	REFERENCIA PART N°	€
6	1/4" BSP	A600304	49,92
10	3/8" BSP	A600306	49,21
13	1/2" BSP	A600308	51,36
20	3/4" BSP	A600312	96,55
25	1" BSP	A600316	140,38
25	1" 1/4 BSP	A600320	181,05
25	1" 1/2 BSP	A600324	187,01

Con agujeros de fijación // Avec des trous de montage // With mounting holes //
Con fori di montaggio

Llave 4 vías rosca hembra BSP (Tipo L)



Robinet haute pression 4 voies série "L" boisseu spherique femelle gaz
Multi-way ball valves female 4 ways (Type L)
Rubinetto 4 vie femmina BSP (Tipo L)

DN	ROSCA THREAD	REFERENCIA PART N°	€
4	1/8" BSP	4KH G 1/8	282,33
6	1/4" BSP	4KH G 1/4	218,97
10	3/8" BSP	4KH G 3/8	241,52
13	1/2" BSP	4KH G 1/2	336,44
20	3/4" BSP	4KH G 3/4	549,98
25	1" BSP	4KH G 1	653,97
25/32	1" 1/4 BSP	4KH G 1 1/4	722,76
25/40	1" 1/2 BSP	4KH G 1 1/2	732,61



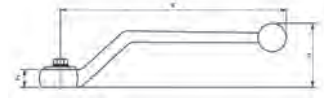

Manetas | Leviers pour Robinets | Handles for Ball-Valves | Manopole

Para llaves de paso Pour robinets For ball-valves Per rubinetti a sfera	SW	Standard zinc Standard zinc Standard zinc Standard zinco		Acero Acier Steel Acciaio		INOX/SS316L	
		Referencia Référence Part no. Codice	€	Referencia Référence Part no. Codice	€	Referencia Référence Part no. Codice	€
Serie BSP 1/8 - 1/4 - 3/8 - 1/2 - 5/8	9	A60013155330	*	C600063	*	Z60013155330	*
Serie DIN 6 - 8 - 10 - 12 - 14 - 15 - 16 - 18							
Serie BSP 3/4 - 1 - 1 1/4	14	-	*	C708618	*	Z60013155331	*
Serie DIN 22 - 25 - 28 - 30 - 35 - 38							
Serie BSP 1 1/4 - 1 1/2 - 2	17	-	*	-	*	Z60013155332	*
Serie DIN 35 - 38 - 42							

Solo se suministra en aluminio | Seulement disponible en aluminium | Only supplied in aluminium | Disponibile solo in alluminio

Para llaves de paso Pour robinets For ball-valves Per rubinetti a sfera	SW	Referencia Référence Part no. Codice	€
Serie BSP 5/8	12	L501741	*
Serie DIN 15 - 16 - 18			

Manetas | Leviers pour Robinets | Handles for Ball-Valves | Manopole



Para llaves de paso Pour robinets For ball-valves Per rubinetti a sfera	SW	Zinc Zinc Zinc Zinco		Aluminio Aluminium Aluminum Alluminio	
		Referencia Référence Part no. Codice	€	Referencia Référence Part no. Codice	€
Serie BSP 1/8 - 1/4 - 3/8 - 1/2 - 5/8	9	AR603722	*	-	*
Serie DIN 6 - 8 - 10 - 12 - 14 - 15 - 16 - 18					
Serie BSP 3/4 - 1 - 1 1/4	14	A60013155331	*	LR606745	*
Serie DIN 22 - 25 - 28 - 30 - 35 - 38					
Serie BSP 1 1/4 - 1 1/2 - 2	17	-	*	LR801799	*
Serie DIN 35 - 38 - 42					

Llaves de paso

Robinets
Ball valves
Rubinetti a sfera

Adaptors

Llave de esfera paso total baja presión



Robinet basse pression 2 voies boisseau spherique passage total pn 16/25

2 Ways ball valve low pressure

Rubinetti a sfera bassa pressione passaggio totale

DN	ROSCA THREAD	REFERENCIA PART N°	€
6	1/4" BSP	BP2V14	5,32
10	3/8" BSP	BP2V38	5,32
13	1/2" BSP	BP2V12	6,55
20	3/4" BSP	BP2V34	10,38
25	1" BSP	BP2V1	15,92
32	1"1/4 BSP	BP2V114	25,07
40	1"1/2 BSP	BP2V112	35,84
50	2" BSP	BP2V2	56,59
80	3" BSP	BP2V3	171,64
100	4" BSP	BP2V4	269,50

ORFS

Quick-release
couplings

Llaves especiales 2 y 3 vías



Robinets speciaux 2 et 3 voies

Special 2 and 3 way valves

Rubinetti spaciali 2 e 3 vie

ROSCA THREAD	Descripción Description	REFERENCIA PART N°	€
1/2" BSP	2 Vías	A600208CC	72,63
1/2" BSP	3 Vías	A60030810	78,73

Ball valves, diverters

Protections

Desviadores

Déviateurs
Diverters
Deviatori di flusso

Desviador de 3 vías rosca hembra BSP



Déviateur manuelle 3 voies femelle BSP
3 Way diverter BSP female
Deviatore di flusso 3 vie femmina

DN	ROSCA THREAD	REFERENCIA PART N°	€
10	3/8" BSP	D3V38	47,81
13	1/2" BSP	D3V12	54,47
20	3/4" BSP	D3V34	63,52
25	1" BSP	D3V10	79,04

Desviador de 4 vías



Déviateur manuelle 4 voies femelle BSP
4 Way diverter BSP female
Deviatore di flusso 4 vie femmina

ROSCA THREAD	REFERENCIA PART N°	€
1/2" BSP	D4V12	68,70
3/8" BSP	D4V38	60,69

Desviador de 6 vías



Déviateur manuelle 6 voies femelle BSP
6 Way diverter BSP female
Deviatore di flusso 6 vie femmina

DN	ROSCA THREAD	REFERENCIA PART N°	€
10	3/8" BSP	D6V38	109,39
13	1/2" BSP	D6V12	121,23

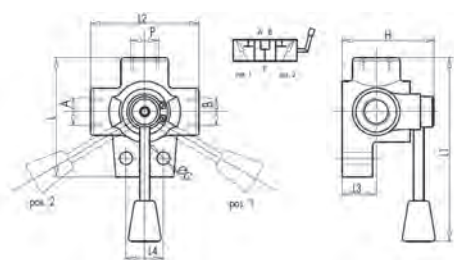

Desviador de 3 vías. Presión máx. 250 bar | Vanne agricole 3 voies. Pression max 250 bar | 3 ways flow divider. Max pressure 250 bar | Deviatori di flusso a 3 vie. Pressione max 250 bar

Referencia Part no.	A-B P Gas	L (mm)	L1 (mm)	L2 (mm)	L3 (mm)	L4 (mm)	ØG (mm)	H (mm)
D3V38	3/8	76	140	68	25	26	8,5	67
D3V12	1/2	87	145	80	28	32	8,5	70
D3V34	3/4	103	150	94	30	32	11	78
D3V10	1	105	152	98	30	32	11	82

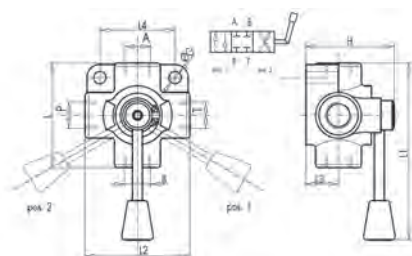

Desviador de 4 vías. Presión máx. 250 bar | Vanne agricole 4 voies. Pression max 250 bar | 4 ways flow divider. Max pressure 250 bar | Deviatori di flusso a 4 vie. Pressione max 250 bar

Referencia Part no.	A-B P-T Gas	L (mm)	L1 (mm)	L2 (mm)	L3 (mm)	L4 (mm)	ØG (mm)	H (mm)
D4V38	3/8	76	140	76	26	54	8,5	72
D4V12	1/2	88	145	88	30	65	8,5	82

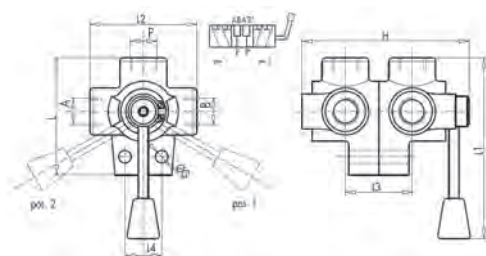

Desviador de 6 vías. Presión máx. 250 bar | Vanne agricole 6 voies. Pression max 250 bar | 6 ways flow divider. Max pressure 250 bar | Deviatori di flusso a 6 vie. Pressione max 250 bar

Referencia Part no.	A-B P Gas	L (mm)	L1 (mm)	L2 (mm)	L3 (mm)	L4 (mm)	ØG (mm)	H (mm)
D6V38	3/8	76	140	68	45	26	8,5	117
D6V12	1/2	87	145	80	51	32	8,5	125

Racores giratorios

Raccords tournants
Swivel fittings
Raccordi girevoli

Adaptors

ORFS

Quick-release couplings

Ball valves, diverters

Protections

Racor giratorio recto



Raccord tournant droit
Straight swivel fittings
Raccordo girevole

ROSCA THREAD	REFERENCIA PART N°	€
1/4" BSP	GGL 1/4	22,39
3/8" BSP	GGL 3/8	23,71
1/2" BSP	GGL 1/2	27,21
3/4" BSP	GGL 3/4	43,48
1" BSP	GGL 1	63,52

Racor giratorio en codo



Raccord tournant coude 90°
Elbow 90° swivel fitting
Raccordo girevole a 90°

ROSCA THREAD	REFERENCIA PART N°	€
1/4" BSP	GG90 1/4	25,25
3/8" BSP	GG90 3/8	28,81
1/2" BSP	GG90 1/2	35,01
3/4" BSP	GG90 3/4	60,28
1" BSP	GG90 1	82,26

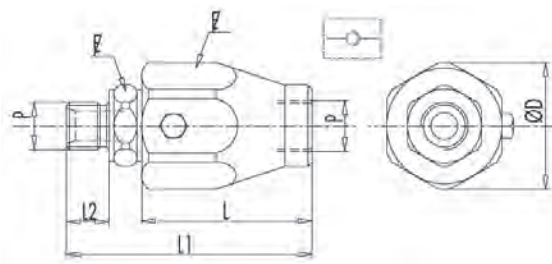

Racor giratorio recto | Raccord tournant droit | In line rotating coupling | Giunti girevoli in linea

Referencia Part no.	P Gas	Caudal máx. Max flow (lt/min)	Velocidad rot. máx. Max rotate speed (turn/min)	Presión máx. en rot. Máx. rotation press (bar)	Presión máx. Máx pressure (bar)	L (mm)	L1 (mm)	L2 (mm)	E (mm)	E1 (mm)	Ø (mm)
GGL 1/4	1/4	25	212	200	400	42	61	11	19	30	33
GGL 3/8	3/8	35	173	200	400	44	66	14	24	34	37
GGL 1/2	1/2	60	160	150	300	47	71	15	27	36	40
GGL 3/4	3/4	100	120	150	300	50	80	19	34	45	49
GGL 1	1	180	100	100	300	57	90	21	41	50	54,5

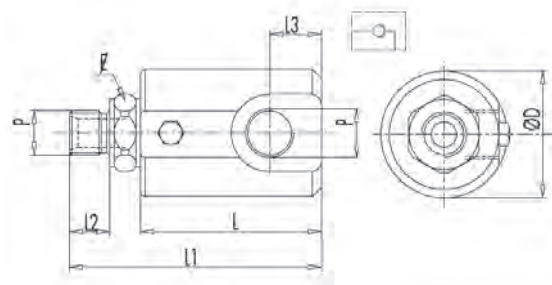

Racor giratorio codo 90° | Raccord tournant coude 90° | 90° rotating coupling | Giunti girevoli a 90°

Referencia Part no.	P Gas	Caudal máx. Max flow (lt/min)	Velocidad rot. máx. Max rotate speed (turn/min)	Presión máx. en rot. Máx. rotation press (bar)	Presión máx. Máx pressure (bar)	L (mm)	L1 (mm)	L2 (mm)	L3 (mm)	E (mm)	ØD (mm)
GG90 1/4	1/4	25	212	200	400	50	69	11	11	19	34
GG90 3/8	3/8	35	173	200	400	54	76	14	13	24	38
GG90 1/2	1/2	60	160	150	300	63	87	15	14	27	40
GG90 3/4	3/4	100	120	150	300	70	100	19	18	34	55
GG90 1	1	180	100	100	300	80	113	21	25	41	60

Gama de productos. Para más información soliciten nuestros catálogos generales o visiten nuestra página web | Gamme de produits. Pour des plus information, nous vous prions de nous demander nos catalogues generals ou visiter notre web-site | Produits range. For any further information, please, enquire us our general catalogues or visit our web-site | Gamma di Prodotti. Per ulteriori información di ricuidete il nostri cataloghi o visitate la Nostra pagina web

INOX AISI 316L

RACORES PARA TUBERÍA FLEXIBLE

EMBOUTS POUR FLEXIBLES

CRIMP FITTINGS FOR HOSES

RACCORDI PER TUBO FLESSIBILE



INOX COARRUGADO

INOX ONDULEUX

CONVOLUTED STAINLESS STEEL

INOX CORRUGATO



ACCESORIOS

ACCESSOIRES

ACCESSORIES

ACCESSORI



RACORES TUBO RÍGIDO

RACCORDS TUBE RIGIDE

PIPE FITTINGS

RACCORDI PER TUBO RIGIDO



RACORES INDUSTRIALES

EMBOUTS INDUSTRIELS

INDUSTRIAL FITTINGS

RACCORDI INDUSTRIALI



▶ Tapones de plástico

Capuchons plastique | Plastic plugs | Tappi di plastica

Adaptors

- ▶ **Tapones hembra para roscas macho** | Capuchons plastique femelle pour filetage mâle | Female plugs for male thread | Tappi femmina per filettature maschio

255



TFG



TFM



TFU

ORFS

- ▶ **Tapones para bridas** | Capuchons plastique de brides sae | Plugs for flanges | Tappi per flange

255



TS 3000



TS 6000

Quick-release couplings

- ▶ **Tapones macho para roscas hembra** | Bouchons plastique mâle pour filetage femelle | Male plugs for female thread | Tappi maschio per filettature femmina

256



TMG



TMM



TMU

Ball valves, diverters

- ▶ **Cinta Teflón** | Rublan Teflon | PTFE Tape | Nastro di teflon

256



M29990

Protections

Muelles

Ressorts | Springs | Molle

▶ **Muelles de plástico** | Ressorts plastique | Plastic springs | Molla di plastica

257



AMUELLE P



AMUELLE P



AMUELLE P

▶ **Muelles metálicos** | Ressorts metaliques | Metallic springs | Molla metallica

258



AMUELLE

Protecciones textiles

Protection textile | Textile protection | Protezioni tessili

Adaptors

▶ **Protección textil** | Protection textile | Textile protection | Protezioni tessile

259



GT



ABRAZADERA

ORFS

▶ **Protección fibra de vidrio** | Protection en fibre de verre | Fiberglass protection | Protezione in fibra di vetro

260



AVIDRIO



AVIDRIO S

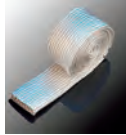

AVIDRIO FA

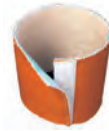

ROVISIVE

Quick-release
couplings

▶ **Protección fibra cerámica** | Protection en fibre de céramique | Ceramic fiber protection | Protezione in fibra di ceramica

260

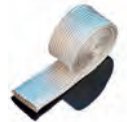

ACERAMICA

Ball valves, diverters

Protections

Fijaciones de seguridad

Systeme de sécurité anti-fouet | Safety fixation | Fune di sicurezza

▶ Elementos de fijación de seguridad | Système de sécurité anti-fouet | Safety fixation elements | Componenti per fune di sicurezza 262



STOPFUDIN
CONF



STOPFS CONF



STOPFUSAE
CONF

Tapones de plástico

Capuchons plastique
Plastic plugs
Tappi di plastica

Tapón hembra rosca BSP



Capuchons plastique femelle - gaz
Female plug - BSP thread
Tappo femmina BSP

DN	REFERENCIA PART N°	€
1/8"	TFG 1/8	0,08
1/4"	TFG 1/4	0,10
3/8"	TFG 3/8	0,10
1/2"	TFG 1/2	0,13
5/8"	TFG 5/8	0,11
3/4"	TFG 3/4	0,14
1"	TFG 1	0,23
1"1/4	TFG 1 1/4	0,28
1"1/2	TFG 1 1/2	0,32
2"	TFG 2	0,54

Tapón hembra rosca Métrica



Capuchons plastique femelle - Métriques
Female plug - Metric thread
Tappo femmina Metrico

DN	REFERENCIA PART N°	€
12x1.5	TFM 12X1.5	0,10
14x1.5	TFM 14X1.5	0,10
16x1.5	TFM 16X1.5	0,11
18x1.5	TFM 18X1.5	0,13
20x1.5	TFM 20X1.5	0,13
22x1.5	TFM 22X1.5	0,13
24x1.5	TFM 24X1.5	0,19
26x1.5	TFM 26X1.5	0,15
30x2	TFM 30X2	0,19
36x2	TFM 36X2	0,24
42x2	TFM 42X2	0,28
52x2	TFM 52X2	0,40

Tapón hembra rosca UNF/ JIC



Capuchons plastique femelle - JIC-UNF
Female plug - UNF (JIC) thread
Tappo femmina UNF/JIC

DN	REFERENCIA PART N°	€
7/16"	TFU 7/16	0,10
1/2"	TFU 1/2	0,10
9/16"	TFU 9/16	0,10
3/4"	TFU 3/4	0,13
7/8"	TFU 7/8	0,13
1"1/16	TFU 1 1/16	0,15
1"5/16	TFU 1 5/16	0,23
1"5/8	TFU 1 5/8	0,28
1"7/8	TFU 1 7/8	0,32

Tapón para bridas 3000 PSI



Capuchons plastique de brides SAE 3000 PSI
Plugs for 3000 PSI flanges
Tappo per flange 3000 PSI

DN	REFERENCIA PART N°	€
30,2	TS 3000 1/2	0,23
38,1	TS 3000 3/4	0,16
44,5	TS 3000 1	0,25
50,8	TS 3000 1 1/4	0,26
60,3	TS 3000 1 1/2	0,30
71,4	TS 3000 2	0,35

Tapón para bridas 6000 PSI



Capuchons plastique de brides SAE 6000 PSI
Plugs for 6000 PSI flanges
Tappo per flange 6000 PSI

DN	REFERENCIA PART N°	€
31,8	TS 6000 1/2	0,21
41,3	TS 6000 3/4	0,23
47,6	TS 6000 1	0,27
54	TS 6000 1 1/4	0,30
63,5	TS 6000 1 1/2	0,33
79,4	TS 6000 2	0,33

Tapones de plástico

Capuchons plastique
Plastic plugs
Tappi di plastica

Adaptors

ORFS

Quick-release
couplings

Ball valves, diverters

Protections

Tapón macho rosca BSP



Bouchons plastique mâle - gaz
Male plug for BSP thread
Tappo maschio BSP

DN	REFERENCIA PART N°	€
1/8"	TMG 1/8	0,09
1/4"	TMG 1/4	0,10
3/8"	TMG 3/8	0,12
1/2"	TMG 1/2	0,15
5/8"	TMG 5/8	0,14
3/4"	TMG 3/4	0,19
1"	TMG 1	0,28
1"1/4	TMG 1 1/4	0,42
1"1/2	TMG 1 1/2	0,57
2"	TMG 2	0,63

Tapón macho rosca Métrica



Bouchons plastique mâle - Métriques
Male plug for Metric thread
Tappo maschio Metrico

DN	REFERENCIA PART N°	€
12x1.5	TMM 12X1.5	0,10
14x1.5	TMM 14X1.5	0,11
16x1.5	TMM 16X1.5	0,12
18x1.5	TMM 18X1.5	0,14
20x1.5	TMM 20X1.5	0,15
22x1.5	TMM 22X1.5	0,15
24x1.5	TMM 24X1.5	0,17
26x1.5	TMM 26X1.5	0,19
30x2	TMM 30X2	0,23
36x2	TMM 36X2	0,32
42x2	TMM 42X2	0,42
45x2	TMM 45X2	0,50
52x2	TMM 52X2	0,62

Tapón macho rosca UNF/ JIC



Bouchons plastique mâle - JIC-UNF
Male plug for unf (JIC) thread
Tappo maschio UNF/JIC

DN	REFERENCIA PART N°	€
7/16"	TMU 7/16	0,09
1/2"	TMU 1/2	0,10
9/16"	TMU 9/16	0,11
3/4"	TMU 3/4	0,14
7/8"	TMU 7/8	0,15
1"1/16	TMU 1 1/16	0,19
1"5/16	TMU 1 5/16	0,27
1"5/8	TMU 1 5/8	0,44
1"7/8	TMU 1 7/8	0,57

Cinta Teflón



Rublan Teflon
PTFE Tape
Nastro di teflon

Descripción Description	REFERENCIA PART N°	€
Rollo suelto: 12 mm x 12 mt x 0,076 mm	M299900	0,67
Plástico de 10 rollos	M2999010	5,81
Caja de 200 rollos	M29990200	101,97

Muelles

Ressorts
Springs
Molle

Muelle de plástico perfil 8x1



R ressort plastique profil 8x1
Plastic spring profile 8x1
Molla di plastica 8x1

DN	LONGITUD (M) LENGTH (M)	REFERENCIA PART N°	€
12	50	AMUELLE P12	3,67

Muelle de plástico perfil 16x1



R ressort plastique profil 16x1
Plastic spring profile 16x1
Molla di plastica 16x1

DN	LONGITUD (M) LENGTH (M)	REFERENCIA PART N°	€
15	50	AMUELLE P15	4,23
16	50	AMUELLE P16	4,12
17	50	AMUELLE P17	4,33
18	50	AMUELLE P18	4,25
20	50	AMUELLE P20	4,31
22	50	AMUELLE P22	3,94
25	50	AMUELLE P25	5,16
28	50	AMUELLE P28	6,01
30	50	AMUELLE P30	6,22

Muelle de plástico perfil 16x2



R ressort plastique profil 16x2
Plastic spring profile 16x2
Molla di plastica 16x2

DN	LONGITUD (M) LENGTH (M)	REFERENCIA PART N°	€
33	20	AMUELLE P33	9,60
35	20	AMUELLE P35	9,78
40	20	AMUELLE P40	10,21
45	20	AMUELLE P45	11,56
50	20	AMUELLE P50	12,44
55	20	AMUELLE P55	14,70
60	20	AMUELLE P60	16,46
70	20	AMUELLE P70	20,02
80	20	AMUELLE P80	23,13

AMUELLE P15

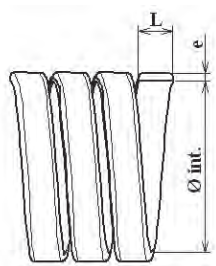

Dimensiones de los muelles de plástico:
Dimensions des ressorts en plastique:
Dimensions of the plastic springs:
Dimensioni della molla di plastica:

L = 16 mm
e = 1 mm
DN = 15 mm

AMUELLE 16

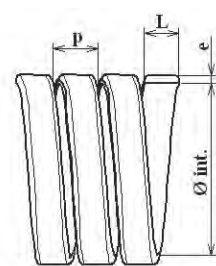

Dimensiones de los muelles metálicos:
Dimensions des ressorts métallique plat:
Dimensions of the metalic flat springs:
Dimensioni della molla metallica piatta:

L = 5 mm
e = 1 mm
DN = 16 mm
p = 8 mm

Muelles

Ressorts
Springs
Molle

Adaptors

ORFS

Quick-release
couplings

Ball valves, diverters

Protections

Muelle metálico plano perfil 5x1



Ressort metalique plat profil 5x1

Flat metallic spring 5x1

Molla metallica piatta 5x1

DN	REFERENCIA PART N°	€
16	AMUELLE16	8,63
18	AMUELLE18	8,68
20	AMUELLE20	8,82
22	AMUELLE22	9,39
24	AMUELLE24	9,91
26	AMUELLE26	10,38
28	AMUELLE28	11,89
30	AMUELLE30	12,17
32	AMUELLE32	12,36
34	AMUELLE34	12,97
38	AMUELLE38	13,77
40	AMUELLE40	14,25
42	AMUELLE42	15,28
47	AMUELLE47	16,46
52	AMUELLE52	17,12
60	AMUELLE60	19,34
68	AMUELLE68	23,73
72	AMUELLE72	24,86

► Podemos suministrar muelles metálicos redondos en acero galvanizado bajo plano. Consúltenos

Nous pouvons fournir ressort métalliques rond en acier galvanisé sur plan. Consultez-nous.

We can supply rounded metallic springs in galvanized steel under drawing. Please, enquire us.

Possiamo fornire molle metalliche rotonde in acciaio galvanizzato su ordine. Richieda.

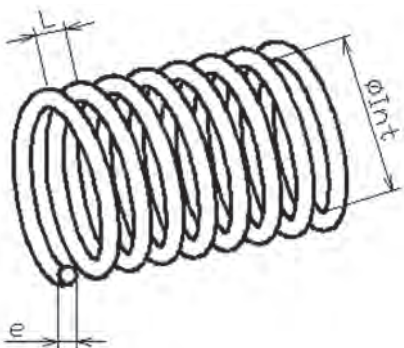

Datos necesarios para consultar: | Données nécessaires pour consulter: | Necessary data to enquire: | Dati necessari per l'ordine:

L = espacio entre alambres | place entre fils de fer | space between wires | spazio tra

e = espesor alambre | wire thickness | épaisseur | spessore

ø = ø interior del muelle | ø int. | ø int. wire | interno della molla

Longitud del muelle | Longueur du ressort | Spring length | Longhezza della molla

Protecciones textiles

Protection textile
Textile protection
Protezioni tessili

259

Tubo de protección textil



Gaine de protection textile
Textile protection tube
Tubo di protezioni tessile

Ø int	L (mm) SIZE	REFERENCIA PART N°	€
22	35	GT35	1,28
25	40	GT40	1,38
28	45	GT45	1,71
31	50	GT50	1,82
35	55	GT55	2,00
41	65	GT65	2,29
50	80	GT80	3,00
76	120	GT120	3,75

Accesorios tubo de protección textil



Accessoires pour gaine de protection textile
Textile protection tube accessories
Accessori per la protezione dei tessili

Ø int max	Ø int min	REFERENCIA PART N°	€
18	15	ABRAZADERA 15-18	0,82
23	20	ABRAZADERA 20-23	0,82
25	22	ABRAZADERA 22-25	0,93
27	23	ABRAZADERA 23-27	1,00
28	25	ABRAZADERA 25-28	1,09
43	40	ABRAZADERA 40-43	2,15
46	43	ABRAZADERA 43-46	2,43



Adaptors

ORFS

Quick-release
couplings

Ball valves, diverters

Protections

Protecciones textiles

Protection textile
Textile protection
Protezioni tessili

Adaptors

ORFS

Quick-release couplings

Ball valves, diverters

Protections

Tubo de fibra de vidrio



Gaine de fibre de verre
Fibreglass tube
Tubo di fibra di vetro

L (mm)	Ø int max	Ø int min	REFERENCIA PART N°	€
15	15	12	AVIDRIO 15	2,82
20	18	16	AVIDRIO 20	3,76
25	22	18	AVIDRIO 25	4,70
30	28	25	AVIDRIO 30	5,64
35	32	28	AVIDRIO 35	6,90
40	35	30	AVIDRIO 40	7,52
45	42	38	AVIDRIO 45	8,78
50	48	45	AVIDRIO 50	14,05
60	52	48	AVIDRIO 60	13,79
75	72	70	AVIDRIO 75	17,56

Tubo de fibra de vidrio siliconado



Gaine de fibre de verre siliconé
Silicone fibreglass tube
Tubo di fibra di vetro siliconato

DN	REFERENCIA PART N°	€
12	AVIDRIO S 12	28,30
16	AVIDRIO S 16	21,78
19	AVIDRIO S 19	25,08
28	AVIDRIO S 28	39,50
32	AVIDRIO S 32	40,66
38	AVIDRIO S 38	42,04
51	AVIDRIO S 51	63,82
70	AVIDRIO S 70	126,39

Tubo de fibra cerámica



Gaine de fibre de céramique
Ceramic fibre tube
Tubo in fibra di ceramica

DN	REFERENCIA PART N°	€
15	ACERAMICA 15	*
20	ACERAMICA 20	*
25	ACERAMICA 25	*
30	ACERAMICA 30	*
40	ACERAMICA 40	*
50	ACERAMICA 50	*
60	ACERAMICA 60	*
70	ACERAMICA 70	*

Tubo de fibra de vidrio saturada

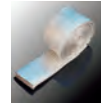

Gaine de fibre de verre saturé
Saturated fibreglass tube
Tubo in fibra di vetro saturato

Ø int max	Ø int min	REFERENCIA PART N°	€
1" 3/4	1"	AVIDRIO FA 16	22,92
2" 1/4	1" 1/2	AVIDRIO FA 24	35,33
4"	2" 1/2	AVIDRIO FA 40	56,25

Revestimiento de fibra de vidrio con velcro



Revêtement de fibre de verre avec velcro
Fibreglass with velcro shield
Rivestimento di fibra di vetro con velcro

DN	REFERENCIA PART N°	€
1" 1/2	ROVISIVE 24	92,47
2"	ROVISIVE 32	107,87
2" 3/4	ROVISIVE 44	130,43

AVIDRIO

Tubo de fibra de vidrio | Fibreglass tube

Fibra de alta calidad tipo E, no se quema y soporta exposiciones a temperaturas de 540 °C. Resiste la mayoría de ácidos y alcalinos y no le afecta la mayoría de disolventes ni lejías/blanqueantes.

High-quality fiber type E, no burns and supports exposure to temperatures of 540 °C. Resists most acids and alkalis and is unaffected by most solvents or bleach.

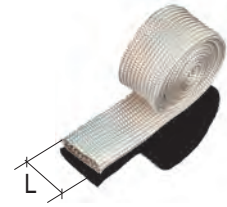

AVIDRIO S

Tubo de fibra de vidrio siliconado | Silicone fibreglass tube

Diseñado para proteger mangueras, alambres, etc, de los peligros del calor elevado y de las llamas ocasionales. Protección continua a 260 °C, soporta picos de hasta 1200 °C. Es resistente a fluidos hidráulicos, aceites lubricantes y combustibles. La funda siliconada protege contra la pérdida de energía en tubo rígido y manguera.

Designed to protect hoses, wires and cables from the hazards of high heat an occasional flame. It protects continuously to 260 °C and will withstand a molten splash at 1200 °C. Resistant to hydraulic fluids, lubricating oils and fuels, it insulates against energy loss in piping and hosing

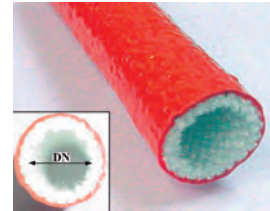

AVIDRIO FA

Fibra de vidrio saturada | Saturated fibreglass tube

Proporciona protección continua hasta 540 °C. Es resistente a la mayoría de ácidos y alcalinos y no le afectan la mayoría de los disolventes ni lejías/blanqueantes. Es altamente flexible y adaptable, esto que permite que una misma protección pueda colocarse en varios diámetros de tubo, o incluso en montajes ya terminados (manguera/ tubo + conexión/rácor). También es muy útil en longitudes largas de manguera o cable.

Provides continuous protection up to 540 °C. It is resistant to most acids and alkalis and is not affected by most of the solvents or bleach. It is highly flexible and adaptable, this allows to place the same protection on various diameters of pipe, or even on already finished assemblies (hose / pipe + connection / fitting). It is also useful in long lengths of hose or cable.

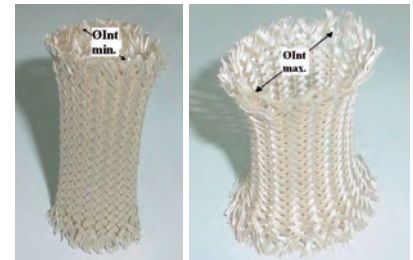

ROVISIVE

Revestimiento de fibra de vidrio siliconada con velcro | Silicon fibreglass with velcro shield

Diseñado para proteger mangueras, alambres, etc, de los peligros del calor elevado y de las llamas ocasionales. Protección continua a 260 °C, soporta picos de hasta 1200 °C. Su sistema de cierre con velcro permite el montaje in situ sin necesidad de quitar y poner los racores y terminales

Designed to protect hoses, wires and cables from the hazards of high heat an occasional flame. It protects continuously to 260 °C and will withstand a molten splash at 1200 °C. Its Velcro closure system allows application in-situ without the need to simantle and reconnect fittings and terminations.

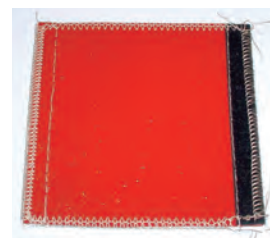
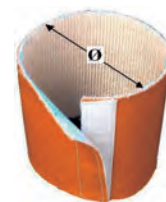

ACERAMICA

Tubo de fibra cerámica | Ceramic fibre tube

La fibra cerámica está compuesta de silicato de aluminio. Es considerablemente resistente a altas temperaturas y tiene una estabilidad química excelente, resiste a los agentes más corrosivos, con la excepción del ácido fosfórico, ácido clorhídrico y bases fuertes. Tiene una excelente insonorización y aislamiento eléctrico, es de baja densidad y alta flexibilidad. No gotea en caso de incendio (no contiene agua). Sus características térmicas y físicas no se alteran por el agua, vapor o aceite.

Ceramic fibre is composed of aluminium silicate. Is considerably resistant to high temperatures and has excellent chemical stability, resists to most corrosive agents, with the exception of phosphoric acid, hydrochloric acid and strong alkalis. It has excellent sound-proofing and electric insulation, low density and high flexibility. Not dripping in case of fire (do not contain water). Its thermal and physical characteristics are not altered by water, steam or oil.



Fijaciones de seguridad

Systeme de sécurité anti-fouet
Safety fixation
Fune di sicurezza

Adaptors

ORFS

Quick-release couplings

Ball valves, diverters

Protections

Protección para DIN 2353



Platines de fixation pour DIN 2353
Retaining system to DIN 2353
Protezione per DIN 2353

Ø int	REFERENCIA PART N°	€
14.5 mm	STOPFUDIN 145 CONF	17,45
17 mm	STOPFUDIN 17 CONF	17,45
18.5 mm	STOPFUDIN 185 CONF	17,45
20.5 mm	STOPFUDIN 205 CONF	17,45
22.5 mm	STOPFUDIN 225 CONF	17,75
24.5 mm	STOPFUDIN 245 CONF	17,75
26.5 mm	STOPFUDIN 265 CONF	17,75
30.5 mm	STOPFUDIN 305 CONF	18,35
34 mm	STOPFUDIN 34 CONF	19,25
36.5 mm	STOPFUDIN 365 CONF	19,25
42.5 mm	STOPFUDIN 425 CONF	19,85
45.5 mm	STOPFUDIN 455 CONF	19,85
49 mm	STOPFUDIN 49 CONF	19,85
52.5 mm	STOPFUDIN 525 CONF	20,46
60 mm	STOPFUDIN 60 CONF	20,46

Abrazaderas



Colliers de fixation stopflex
Fixation clamps
Collari fissatubo

Ø int	REFERENCIA PART N°	€
18-20 mm	STOPFS 22-24 CONF	4,66
21-23 mm	STOPFS 25-27 CONF	4,81
24-26 mm	STOPFS 28-30 CONF	4,81
27-29 mm	STOPFS 31-33 CONF	4,81
30-32 mm	STOPFS 34-36 CONF	5,11
33-35 mm	STOPFS 37-39 CONF	5,57
36-39 mm	STOPFS 40-43 CONF	5,72
40-43 mm	STOPFS 44-47 CONF	5,72
44-47 mm	STOPFS 48-51 CONF	5,72
48-51 mm	STOPFS 52-55 CONF	7,52
52-56 mm	STOPFS 56-60 CONF	7,52
57-61 mm	STOPFS 61-65 CONF	7,82
62-66 mm	STOPFS 66-70 CONF	8,72
67-73 mm	STOPFS 71-77 CONF	9,03
72-78 mm	STOPFS 76-82 CONF	9,03

Protección para bridas



Platines de fixation pour brides
Retaining system for flanges
Protezione per flange

Ø int	REFERENCIA PART N°	€
8.5 mm	STOPFUSAE 085 CONF	20,76
10.5 mm	STOPFUSAE 105 CONF	20,46
12.5 mm	STOPFUSAE 125 CONF	21,06
14.5 mm	STOPFUSAE 145 CONF	21,06
16.5 mm	STOPFUSAE 165 CONF	21,06
20.5 mm	STOPFUSAE 205 CONF	21,06

Fijaciones de seguridad

Système de sécurité anti-fouet | Safety system | Fune di sicurezza

Referencia Référence Part No. Codice	Ø	SP	Recomendado para Recommandé pour Recommended for Consigliato per
STOPFUDIN 145 CONF	14,5	2,5	8L - 1/4"
STOPFUDIN 17 CONF	17	2,5	8S - 10L - 3/8"
STOPFUDIN 185 CONF	18,5	2,5	10S - 12L
STOPFUDIN 205 CONF	20,5	2,5	12S
STOPFUDIN 225 CONF	22,5	2,5	14S - 15L - 1/2"
STOPFUDIN 245 CONF	24,5	2,5	16S - 5/8"
STOPFUDIN 265 CONF	26,5	2,5	18L - 3/4"
STOPFUDIN 305 CONF	30,5	3	20S - 22L
STOPFUDIN 34 CONF	34	3	1"
STOPFUDIN 365 CONF	36,5	3	25S - 28L
STOPFUDIN 425 CONF	42,5	3	30S - 1" 1/4
STOPFUDIN 455 CONF	45,5	3	35L
STOPFUDIN 49 CONF	49	3	1" 1/2
STOPFUDIN 525 CONF	52,5	3	38S - 42L
STOPFUDIN 60 CONF	60	3	2"
STOPFUSAE 085 CONF	8,5	4	BRIDA SAE 1/2" 3000 y 6000 PSI
STOPFUSAE 105 CONF	10,5	4	BRIDA SAE 1/2"-1"-1"1/4 3000 PSI y 3/4" 6000 PSI
STOPFUSAE 125 CONF	12,5	4	BRIDA SAE 1"1/2-2" 3000 PSI y 1" 6000 PSI
STOPFUSAE 145 CONF	14,5	4	BRIDA SAE 1"1/4 6000 PSI
STOPFUSAE 165 CONF	16,5	4	BRIDA SAE 1"1/2 6000 PSI
STOPFUSAE 205 CONF	20,5	4	BRIDA SAE 2" 6000 PSI

